

Mechanical:

REV.	ECN NO.	DESCRIPTION	DATE	APPD
A	REL		2015-06-08	

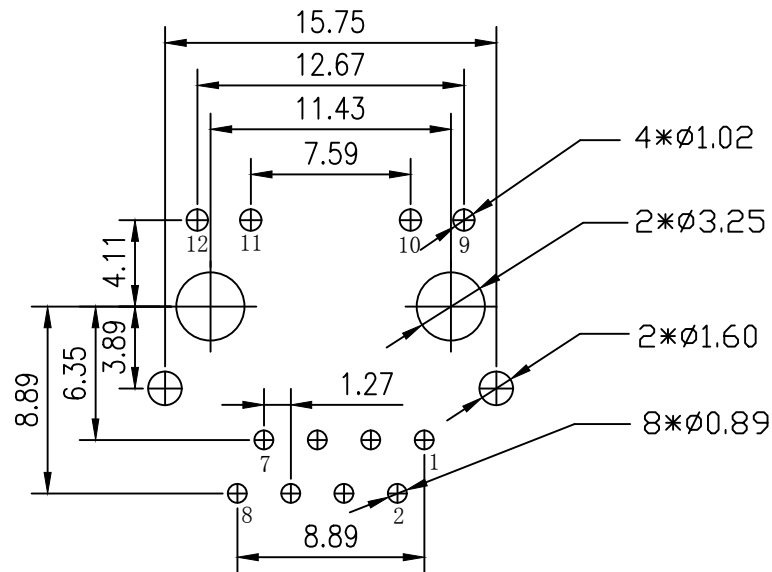

SUGGESTED PCB LAYOUT (TOP VIEW)

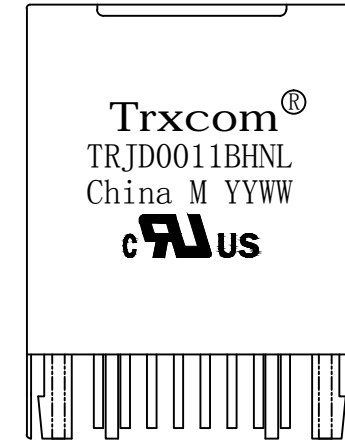
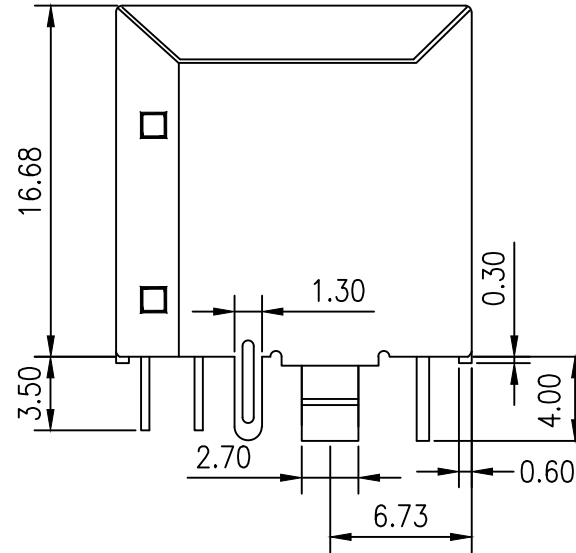
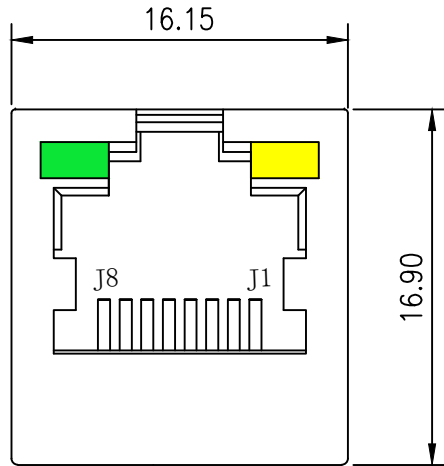

NOTES:

1. Designed to support application, such as SOHO (ADSL modems), LAN-on-Motherboard (LOM), hub and Switches.
2. Meets IEEE 802.3 specification
3. Connector Materials:
 Housing: Thermoplastic UL94V-0
 Contact/Shield: Copper alloy
 Shield plating: Nickel
 Contact plating: Gold 6 micro-inches min. In contact area.
4. Wave solder tip temperature: 265°C Max, 5 Sec.
5. UL Certification: File Number E321120

X:X	±0.25	APPD:	TRXCOM INT'L TECHNOLOGY CO. LTD
X:XX	±0.20	CHKD:	
X:XXX	±0.05	DR: SEA	TITLE: Vertical RJ45 Connector With 10/100 Magnetic
ANGLES	±1°	UNIT: mm	PART NO.: TRJD0011BHNL
	SCALE: 3/1	SHEET: 1/4	REV: A DWG NO.: TRC13122310

Schematic:

REV.	ECN NO.	DESCRIPTION	DATE	APPD
A	REL		2015-06-08	

PC BOARD CONNECTIONS

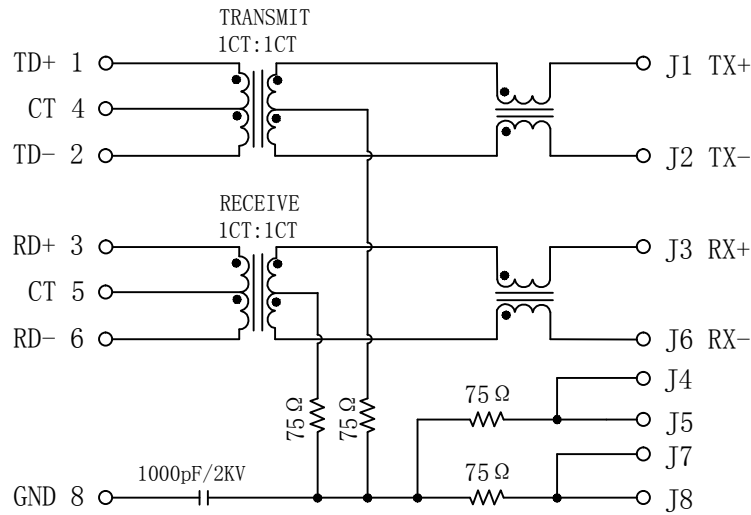

RJ45 CONNECTOR

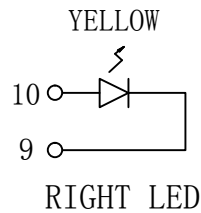
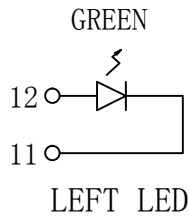

Emitting Color	λ_p (nm)	$V_F @ I_F = 20\text{mA}$	$I_R @ V_R = 5V$
GREEN	565	1.8~2.6V	10 μA max
YELLOW	585	1.8~2.6V	10 μA max

ELECTRICAL SPECIFICATIONS @25°C

- Turn Ratio($\pm 3\%$):
TX=1CT:1CT RX=1CT:1CT
- Inductance OCL:
350uH Min @100KHz 0.1V 8mA DC Bias
- DCR: 1.2 Ω Max
- Insertion Loss:
-1.0dB Max @1-100MHz
- Return Loss:
-18dB Min @1-30MHz
-15dB Min @30-60MHz
-12dB Min @60-100MHz
- Cross talk:
-40dB Min @30MHz
-35dB Min @60MHz
-30dB Min @100MHz
- Common Mode Rejection:
-30dB Min @1-100MHz
- Operating Voltage: 3.3-5V Max.
Current: 350mA.
- Hipot Test: 1500Vrms
- Operating Temperature Range: 0°C ~ 70°C.



X:X	± 0.25	APPD:	TRXCOM INT'L TECHNOLOGY CO. LTD
X:XX	± 0.20	CHKD:	
X:XXX	± 0.05	DR: SEA	TITLE: Vertical RJ45 Connector With 10/100 Magnetic
ANGLES	$\pm 1^\circ$	UNIT: mm	PART NO.: TRJD0011BHNL
	SCALE: 3/1	SHEET: 2/4	REV: A DWG NO.: TRC13122310

Profile of wave solder:

REV.	ECN NO.	DESCRIPTION	DATE	APPD
A	REL		2015-06-08	

SUGGESTED PROFILE OF WAVE SOLDER FOR ROHS PRODUCT

REV: A
 TEMP(°C): 25
 HUM(%): 65 RH

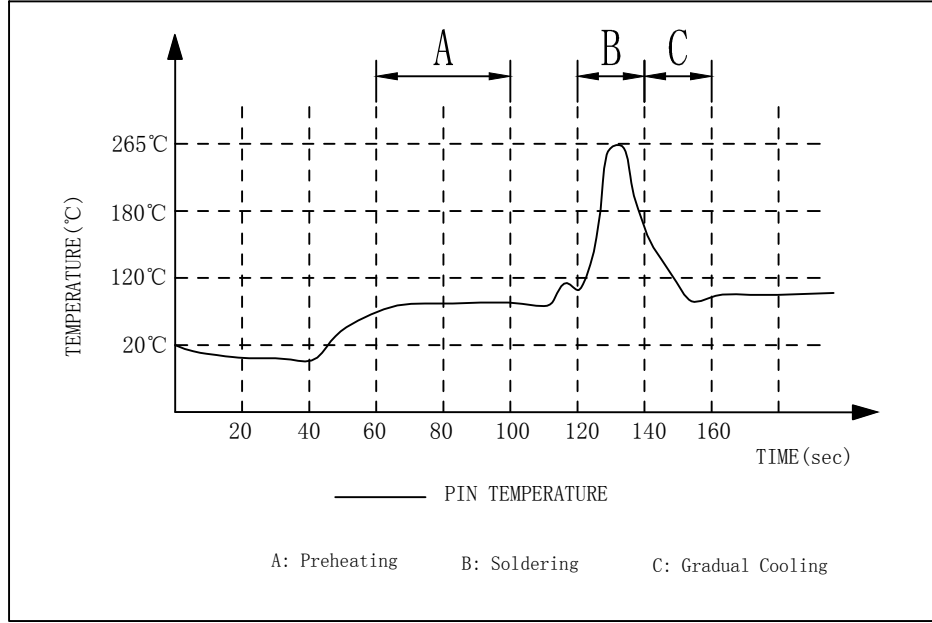

- (1) Tip Temperature: 265°C max
 - (2) Tip Temperature time: 5sec max
- Note: The melting point of Tin: 219°C

X:X	±0.25	APPD:	TRXCOM INT'L TECHNOLOGY CO. LTD	
X:XX	±0.20	CHKD:	TITLE: Vertical RJ45 Connector With 10/100 Magnetic	
X:XXX	±0.05	DR: SEA	PART NO.: TRJD0011BHNL	
ANGLES	±1°	UNIT: mm		
	SCALE: 3/1	SHEET: 3/4	REV: A	DWG NO.: TRC13122310

Packaging:

REV.	ECN NO.	DESCRIPTION	DATE	APPD
A	REL		2015-06-08	

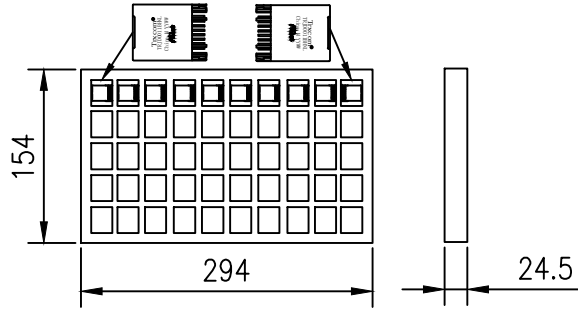

22Tray →

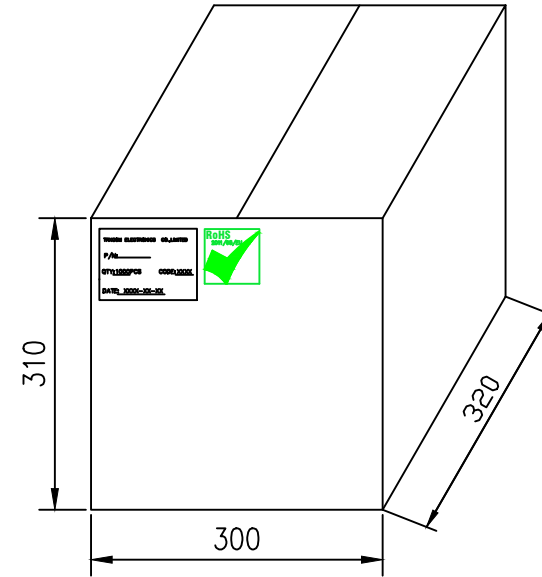

- ◆ Packaging unit: 50pcs/tray
- ◆ Packaging material: PVC
- ◆ Outer carton unit: 1000pcs/20tray/box
- ◆ Net Weight: 7kg
- ◆ Gross Weight: 9kg

X:X	±0.25	APPD:	TRXCOM INT'L TECHNOLOGY CO. LTD
X:XX	±0.20	CHKD:	
X:XXX	±0.05	DR: SEA	TITLE: 1*1 16.68mm Vertical RJ45 Packing
ANGLES	±1°	UNIT: mm	PART NO.: TRJD0011BHNL
	SCALE: 3/1	SHEET: 4/4	REV: A DWG NO.: TRC13122310