

# Mechanical:

REV.	ECN NO.	DESCRIPTION	DATE	APPD
A	REL		2015-06-02	

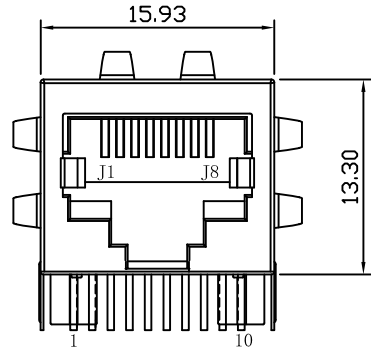

Front Side View

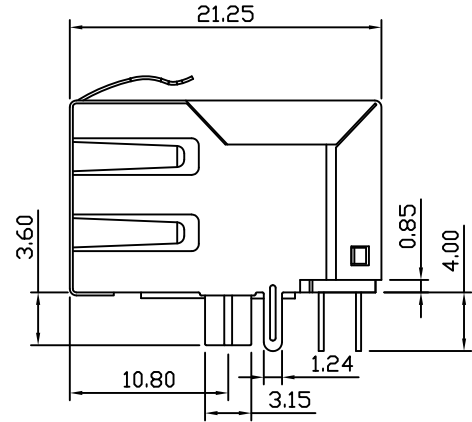

Left Side View

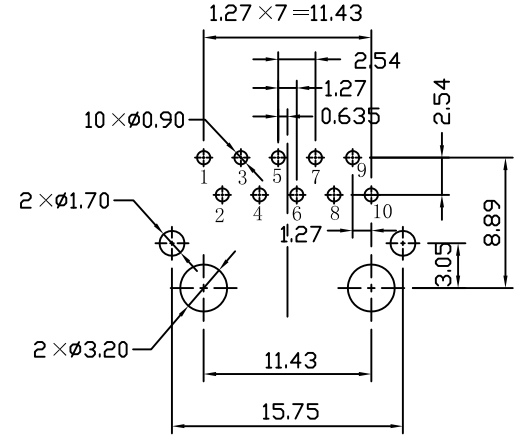

Suggested PCB Layout

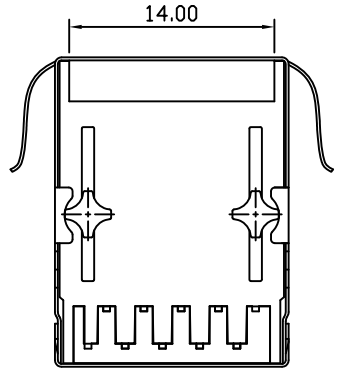

Bottom Side View

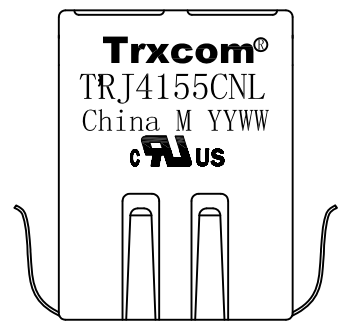

Top Side View

## NOTES:

1. Meets IEEE 802.3AF specification
2. Connector Materials:
  - Housing Material: Thermoplastic PA46+30%G.F UL94V-0
  - Contact Material: Phosphor Bronze C5210R-EH Thickness=0.35mm
  - Pins: Brass C2680R-H Thickness=0.35mm
  - Shield: SUS S201-1/2H Thickness=0.2mm
  - Contact plating: Gold 6 micro-inches min. In contact area.
3. Wave solder tip temperature: 265°C Max, 5 Sec Max
4. UL Certification: File Number E321120

X:X ±0.25	APPD:	<b>Trxcom</b> Huizhou Trxcom Electronics Co., Ltd.
X:XX ±0.20	CHKD:	
X:XXX ±0.05	DR: GRANT	TITLE: RJ45 Connector with 10/100 Base-T Integrated Magnetics & PoE
ANGLES ±1°	UNIT: mm	PART NO.: TRJ4155CNL
	SCALE: 2/1	SHEET: 1/4
	REV: A	DWG NO.: TRC14092231

# Schematic:

REV.	ECN NO.	DESCRIPTION	DATE	APPD
A	REL		2015-06-02	

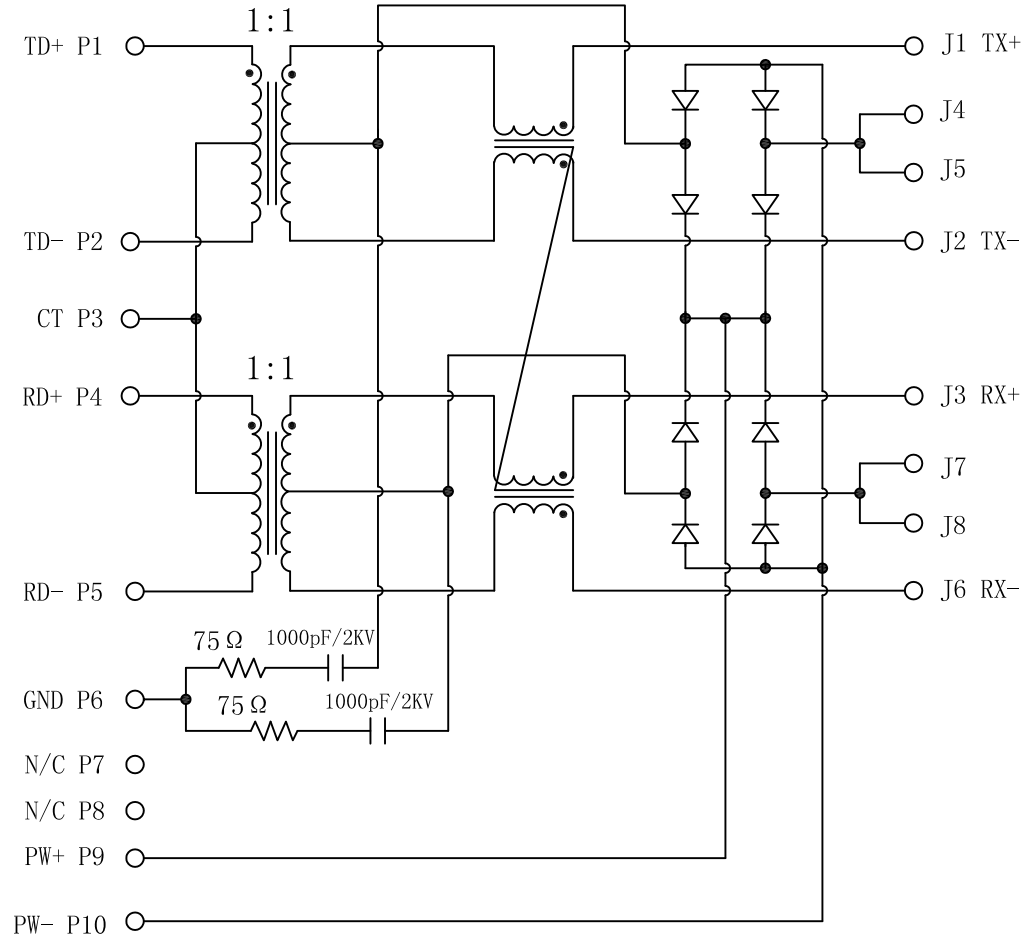

## ELECTRICAL SPECIFICATIONS @25°C

- Turn Ratio( $\pm 3\%$ ):  
TX=1CT:1CT      RX=1CT:1CT
- Inductance OCL:  
350uH MIN @ 100KHz 0.1V 8mA DC Bias
- DCR:  
1.2  $\Omega$  MAX
- Insertion Loss:  
-1.0dB MAX @ 1-100MHz
- Return Loss:  
-18dB MIN @ 1-30MHz  
-15dB MIN @ 30-60MHz  
-12dB MIN @ 60-100MHz
- Cross talk:  
-40dB MIN @ 1-30MHz  
-35dB MIN @ 30-60MHz  
-30dB MIN @ 60-100MHz
- Common Mode Rejection:  
-30dB MIN @ 1-50MHz  
-20dB MIN @ 50-150MHz
- Balanced DC Line Current:  
350mA MAX @48VDC
- Hipot Test:1500Vrms
- Operating Temperature Range:-40°C TO +85°C

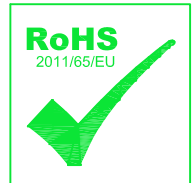

X:X	$\pm 0.25$	APPD:	<b>Trxcom</b> Huizhou Trxcom Electronics Co., Ltd.	
X:XX	$\pm 0.20$	CHKD:		
X:XXX	$\pm 0.05$	DR: GRANT	TITLE: RJ45 Connector with 10/100 Base-T Integrated Magnetics & PoE	
ANGLES	$\pm 1^\circ$	UNIT: mm	PART NO.: TRJ4155CNL	
	SCALE: 2/1	SHEET: 2/4	REV: A	DWG NO.: TRC14092231

# Profile of wave solder:

REV.	ECN NO.	DESCRIPTION	DATE	APPD
A	REL		2015-06-02	

## SUGGESTED PROFILE OF WAVE SOLDER FOR ROHS PRODUCT

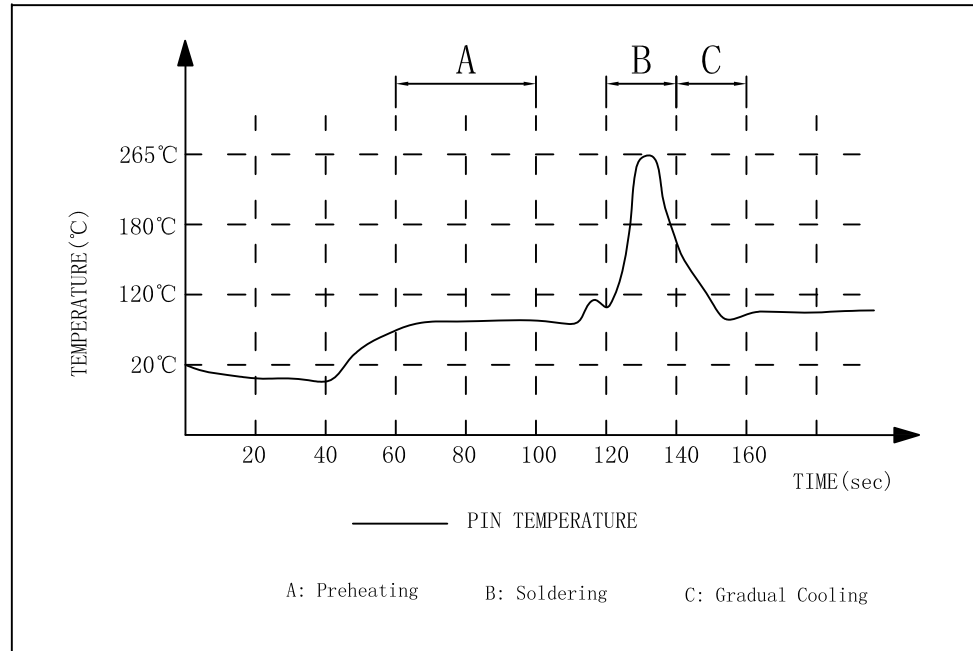

- (1) Tip Temperature: 265°C max
  - (2) Tip Temperature time: 5sec max
- Note: The melting point of Tin: 219°C

X:X ±0.25	APPD:	Trxcom		
X:XX ±0.20	CHKD:	HuiZhou Trxcom Electronics Co., ltd		
X:XXX ±0.05	DR: GRANT	TITLE: RJ45 Connector with 10/100 Base-T Integrated Magnetics & PoE		
ANGLES ±1°	UNIT: mm	PART NO. : TRJ4155CNL		
	SCALE: 2/1	SHEET: 3/4	REV: A	DWG NO. : TRC14092231

Packaging:

REV.	ECN NO.	DESCRIPTION	DATE	APPD.
A	REL		2015-06-02	

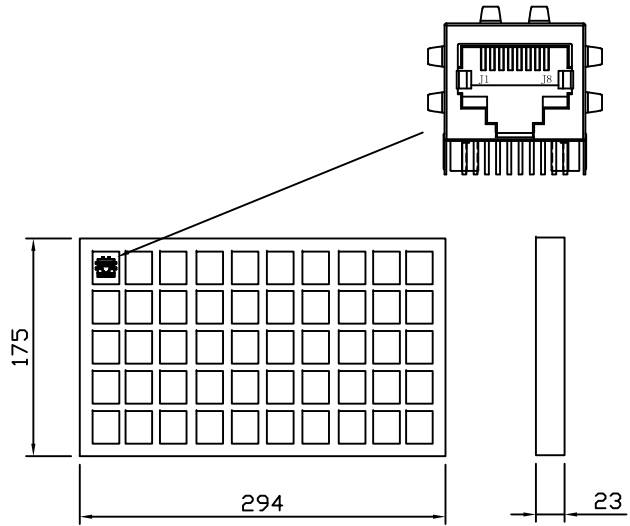

24Tray →

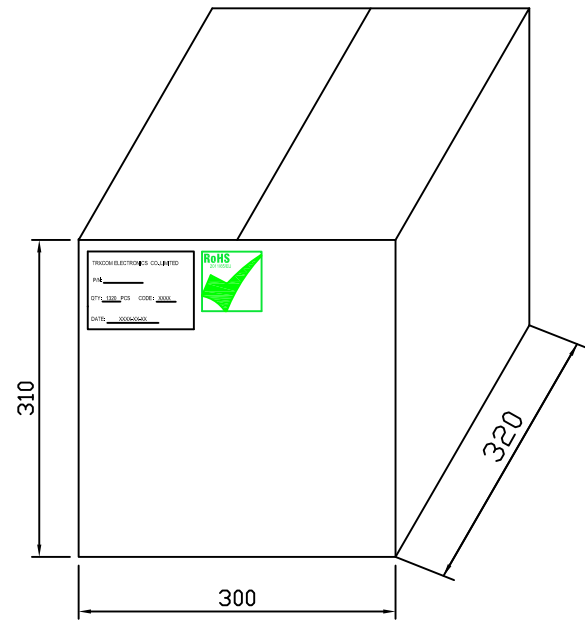

- ◆ Packaging unit :50pcs/tray
- ◆ Packaging material:PVC
- ◆ Outer carton unit:1200pcs/24tray/box
- ◆ Net Weight:8kg
- ◆ Gross Weight:10kg

X:X ±0.25	APPD:	<b>Trxcom</b> Huizhou Trxcom Electronics Co.,Ltd.
X:XX ±0.20	CHKD:	
X:XXX ±0.05	DR: GRANT	TITLE: <b>1*1 21.3 RJ45 PACKING</b>
ANGLES ±1°	UNIT: mm	PART NO.: TRJ4155CNL
	SCALE: 2/1	SHEET: 4/4
	REV: A	DWG NO.: TRC14092231