



**Constant Current Driver**

**Model: SC84W300-1050CG-4**



Model	CH1 /CH2 Current		Input Current	Input Power	Output Power Range	PF	Efficiency	CH1/CH2 Voltage		No load Voltage
SC84W300-1050CG-4	300mA	300mA	0.18A	30.8W	6.00-25.20W	0.86	82%	10-42V	10-42V	55V
	350mA	350mA	0.20A	35.8W	7.00-29.40W	0.87	82%	10-42V	10-42V	55V
	400mA	400mA	0.24A	41W	8.00-33.60W	0.88	82%	10-42V	10-42V	55V
	450mA	450mA	0.26A	45.6W	9.00-37.80W	0.89	83%	10-42V	10-42V	55V
	500mA	500mA	0.28A	50.6W	10.00-42.00W	0.90	83%	10-42V	10-42V	55V
	550mA	550mA	0.30A	55.6W	11.00-46.20W	0.91	83%	10-42V	10-42V	55V
	600mA	600mA	0.32A	60.8W	12.00-50.40W	0.92	83%	10-42V	10-42V	55V
	650mA	650mA	0.34A	65W	13.00-54.60W	0.93	84%	10-42V	10-42V	55V
	700mA	700mA	0.36A	70W	14.00-58.80W	0.94	84%	10-42V	10-42V	55V
	750mA	750mA	0.38A	75W	15.00-63.00W	0.94	84%	10-42V	10-42V	55V
	800mA	800mA	0.42A	80W	16.00-68.20W	0.95	84%	10-42V	10-42V	55V
	850mA	850mA	0.44A	40W	17.00-68.00W	0.95	85%	10-40V	10-40V	55V
	900mA	900mA	0.46A	84.8W	18.00-72.00W	0.96	85%	10-40V	10-40V	55V
	950mA	950mA	0.46A	89.4W	19.00-76.00W	0.96	85%	10-40V	10-40V	55V
	1000mA	1000mA	0.48A	93W	20.00-80.00W	0.97	86%	10-40V	10-40V	55V
1050mA	1050mA	0.48A	97.6W	21.00-84.00W	0.97	86%	10-40V	10-40V	55V	

**\* Test result @230V, 50Hz, Full Load.**

### 1. Parameters

Category	Item	Technical Norm
Features	Output Type	Constant Current
	Output Features	Isolation
	IP Grade	IP20
	Insulation Class	Class II
Input	Rated Input Voltage	220-240VAC
	Range of Input Voltage	176-264VAC or 176-280VDC
	Frequency	50/60Hz

	Input Current	≤0.48A (230VAC, full load)
	Input Power	≤97.6W (230VAC, full load)
	Power Factor	≥0.95 (230VAC, full load)
	THD	≤20% (230VAC, full load)
	No-load Power Consumption	≤0.5W @230VAC
Output	Output Voltage Range	10-42VDC@300-800mA (CH1/CH2) 10-40VDC@850-1050mA (CH1/CH2)
	No Load Voltage	55VDC Max.
	Output Current (CH1/CH2)	300mA -1050mA (Max. output)
	Max. Output Power (CH1/CH2)	84W
	Efficiency	≥86% (230VAC, full load)
	Current Ripple(< 120 Hz)	±5% (Imax-Imin)/(Imax+Imin)
	PstLM	≤1
	SVM	≤0.4
	Current Accuracy	±5%
	Started Delay Time	≤0.5S(230VAC, full load)
Protection	Short Circuit Protection	Auto Recovery
	Overload Protection	Auto Recovery
	No-load Protection	Auto Recovery
	Insulation voltage	3000V 5mA 60S between P-S
	Insulation resistance	>100M ohm @ 500VDC
	Leakage current	< 250µA, I/P to O/P or I/P to PE @230V input
Environment	Ta/Operation Temperature	-20....+35°C
	Ts/Storage Temperature	-40....+85°C
	Tc/Enclosure Temperature	85°C
	Humidity	10%....90%RH
	Atmospheric pressure	86-108KPa
Construction	Connection Method	Push-in Terminal
	Installation	Independent
	SEC Wire preparation	0.5-1.5□
	Dimension	312 x 31 x 45mm (L*W*H)
Standards	Certification	complied to CE
	Safety Standards	EN61347-1:2015,EN61347-2-13:2014/A1:2017,EN62493:2015
	EMC Standards	EN55015:2013/A1:2015,EN61000-3-2:2014, EN61000-3-3:2013,EN61547:2009
	Performance	EN62384
	Surge	L-N/2KV
Others	RoHS	complied to 2011/65/EU
	Life Time	50000h @Ta/ Tc
	Warranty	5years , F.R. < 10000ppm
<b>Remark:</b> 1.All Parameters, if not specified, are measured at 230VAC/50Hz and 25°C ambient temperature. 2.LED Driver is a component of the luminaires, Luminaires and wire layout will affect the EMC, please check the EMC with end products again.		

### 2. Output Current Setting

(CH1/CH2) Output Current	1	2	3	4
300mA	-	-	-	-
350mA	-	-	-	ON
400mA	-	-	ON	-
450mA	-	-	ON	ON
500mA	-	ON	-	-
550mA	-	ON	-	ON
600mA	-	ON	ON	-
650mA	-	ON	ON	ON
700mA	ON	-	-	-
750mA	ON	-	-	ON
800mA	ON	-	ON	-
850mA	ON	-	ON	ON
900mA	ON	ON	-	-
950mA	ON	ON	-	ON
1000mA	ON	ON	ON	-
1050mA	ON	ON	ON	ON

### 3. Connected quantities of different current Breaker

TYPE	Connected quantities of different current Breaker						Input Voltage	Inrush Current	Time
	current (A)	10	13	16	20	25			
	Installation wire diameter	1.5mm <sup>2</sup>	2.5mm <sup>2</sup>	2.5mm <sup>2</sup>	4mm <sup>2</sup>	4mm <sup>2</sup>			
TYPE B		33	43	53	67	83	@230VAC	18	2.8
TYPE C		53	69	85	107	133			
TYPE D		85	111	137	171	213			

### 4. Label

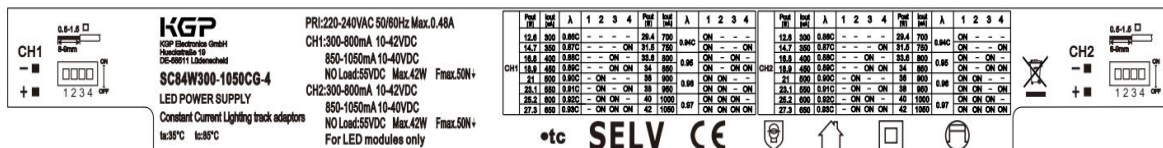

### 5. Lifetimecurve

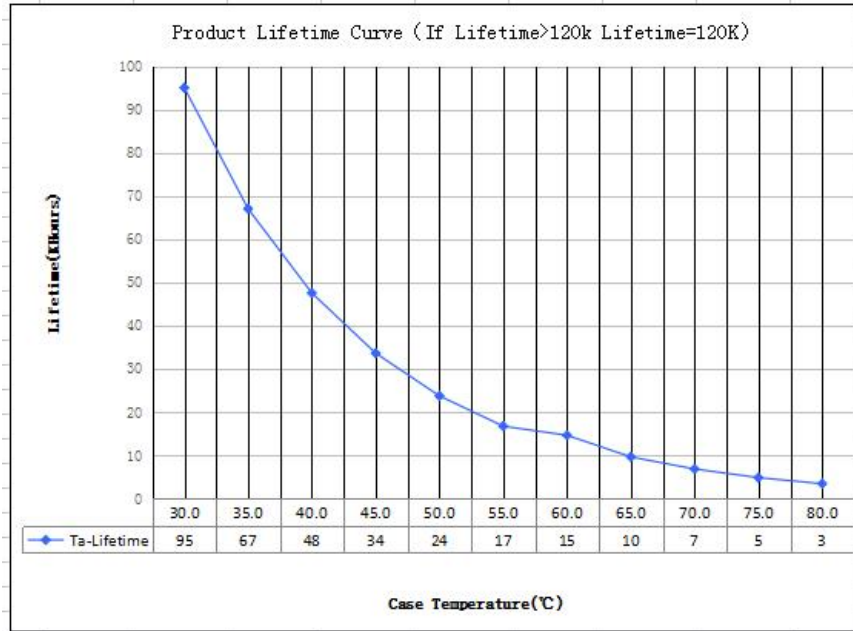

### 6. Dimension

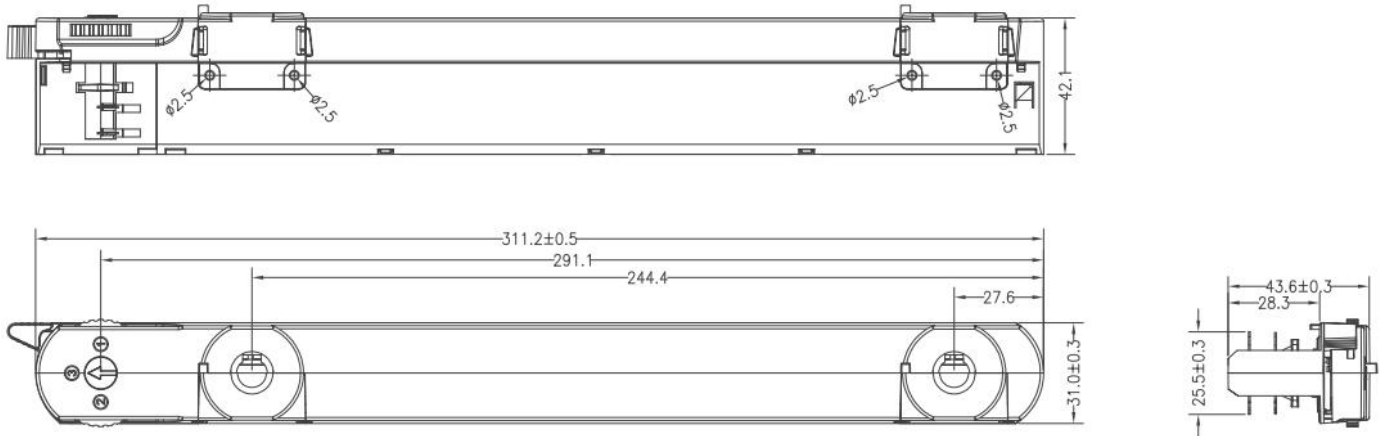

### 7. Wiring Diagram

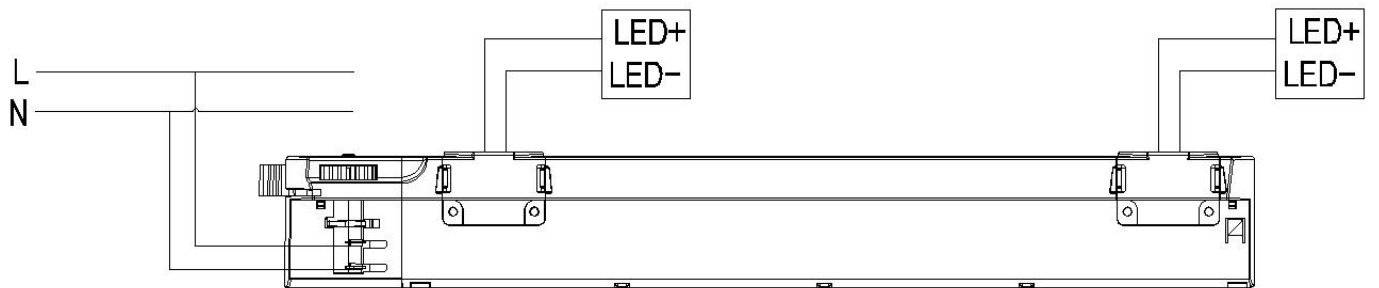

### 8. Packing information

Packing way	Model	Article number	Colour	Carton L*W*H(mm)	Pcs/ Carton	Net weight/ Pcs(kg)	Net weight/ Carton(kg)	Gross weight/ Carton(kg)
industrial	SC84W300-1050CG-4W	121601W	White	515*274*370	60	0.222	13.32	15.17
	SC82W300-1050CG-4B	121601B	Black					
	SC84W300-1050CG-4G	121601G	Grey					

### 9. Lamp Screw Type

- Optional threaded sleeve for luminaire mounting
- Suitable for M10x1x8 threaded nut
- Additional mounting equipment, e.g. M10x1x12
- aluminium, black, white
- further on request

### Ordering data

Type	Colour	Article number	Qty/ctn	Weight/pcs
M10x8	White	AL	PC	9.04
	Black	AL	PC	9.04
	Gray	AL	PC	9.04
M10x12	White	AL	PC	9.72
	Black	AL	PC	9.72
	Gray	AL	PC	9.72

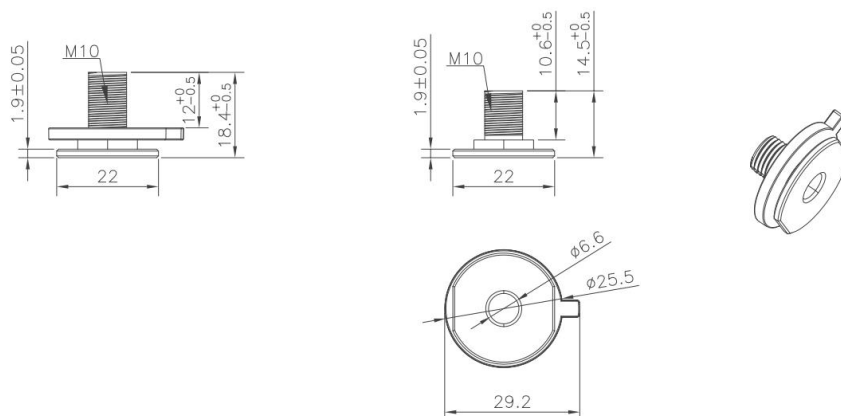

## 10. Suitable for following tracks

Serial number	Brand	Track model	System
1	Global	XTS11 & XTSC611	3P
2	A.A.G STUCCHI	9000-1-ST	3P
3	Eutrac	25-106	3P
4	Unipro	T32B	3P
5	PowerGEAR	Pro-0431L&Pro-D631R	3P
6	ERCO	1079301000	3P
7	BELINIEGRA	4X	3P

### Remark:

1. The model name is XTS11 and XTSC611 tracks, and its brand is Global.
2. The model name used is the 9000-1-ST track, and its brand is A.A.G STUCCHI.
3. The model name is 25-106 tracks, and its brand is Eutrac.
4. The model name is T32B tracks, and its brand is Unipro.
5. The model name is Pro-0431L and Pro-D631R tracks, and its brand is PowerGEAR.
6. The model name is 1079301000 tracks, and its brand is ERCO.
7. The model name is 4X tracks, and its brand is BELINIEGRA

## 11. The model name is 783 tracks, and its brand is ERCO.Phase track light rail specification:

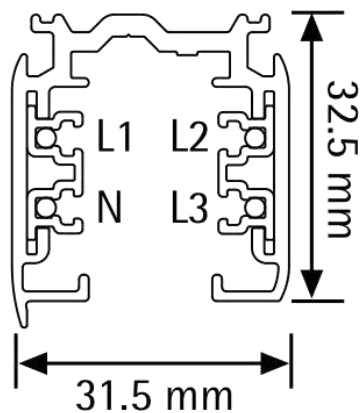
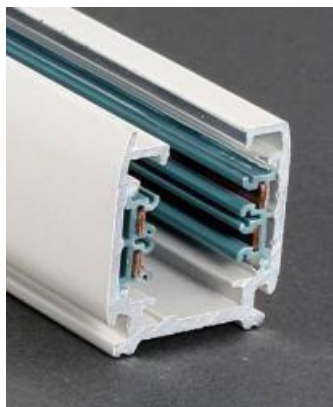

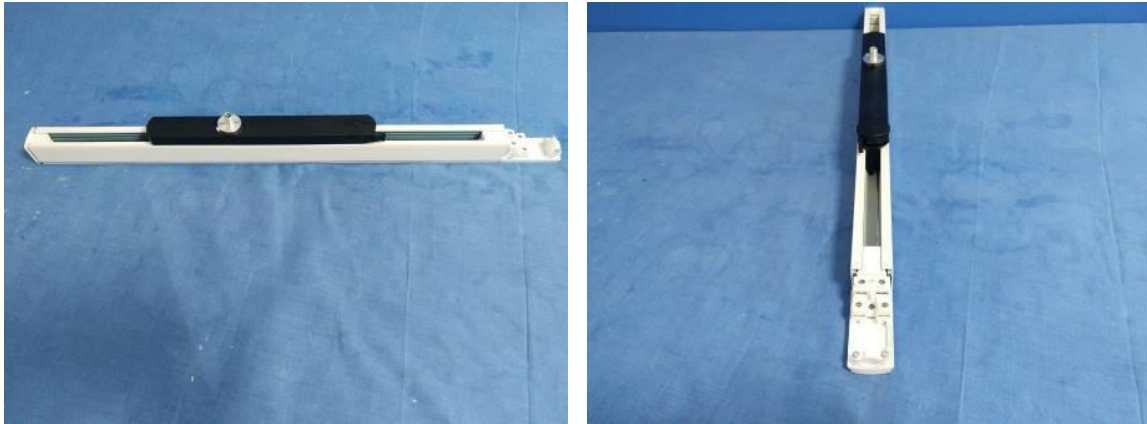
**12. Lighting track adapter and rail system installation diagram:**

**The adaptor shall be given that the use is limited to the track system specified.**

**13. Wiring instructions**

- All connections must be kept as short as possible to ensure good EMI behaviour
- Mains leads should be kept apart from LED Driver and other leads (ideally 5 – 10 cm distance)
- Advice the maximum length of output wires is 3 m
- Secondary switching is not permitted (Except for constant voltage)
- Incorrect wiring can damage LED modules.
- The wiring must be protected against short circuits to earth (sharp edged metals parts, metal cable clips, louver, etc.)