

Constant Current Driver

Model:SC42W300-1050CG-4X DUAL



Model	Output Current	Input Current	Input Power	Output Power Range	PF	Efficiency	Output Voltage	No load Voltage
SC42W300-1050CG-4W DUAL	300mA	0.09A	14.48W	3-12.6W	0.86	86%	10-42V	59V
	350mA	0.10A	16.70W	3.5-14.7W	0.87	87%	10-42V	59V
	400mA	0.12A	19.10W	4-16.8W	0.88	87%	10-42V	59V
	450mA	0.13A	21.48W	4.5-18.9W	0.89	87%	10-42V	59V
	500mA	0.14A	23.60W	5-21W	0.90	87%	10-42V	59V
	550mA	0.15A	25.96W	5.5-23.1W	0.91	88%	10-42V	59V
SC42W300-1050CG-4B DUAL	650mA	0.17A	30.67W	6.5-27.3W	0.93	89%	10-42V	59V
	700mA	0.18A	33.03W	7-29.4W	0.94	90%	10-42V	59V
SC42W300-1050CG-4G DUAL	750mA	0.19A	35.40W	7.5-31.5W	0.94	91%	10-42V	59V
	800mA	0.21A	37.75W	8-33.6W	0.95	91%	10-42V	59V
	850mA	0.22A	38.20W	8.5-34W	0.95	91%	10-40V	59V
	900mA	0.23A	40.45W	9-36W	0.95	91%	10-40V	59V
	950mA	0.25A	42.70W	9.5-38W	0.95	91%	10-40V	59V
	1000mA	0.25A	44.95W	10-40W	0.95	91%	10-40V	59V
	1050mA	0.25A	47.20W	10.5-42W	0.95	91%	10-40V	59V

1. Parameters

category	Item	Technical Norm
Features	Output Type	Constant Current
	Output Features	Isolation
	IP Grade	IP20
	Insulation Class	Class II
	Dimming Type	Color temperature switch
Input	Rated Input Voltage	220-240VAC
	Range of Input Voltage	198-264VAC or 198-280VDC
	Frequency	50/60Hz
	Input Current	≤0.25A
	Input Power	≤47.2W
	Power Factor	≥0.95 (230VAC, full load)

	THD	≤20%
	No-load Power Consumption	≤0.5W @230VAC
Output	Output Voltage Range	10-42VDC@300-800mA 10-40VDC@850-1050mA
	No Load Voltage	59VDC Max.
	Output Current	300mA -1050mA (Max. output)
	Max. Output Power	42W
	Efficiency	≥91% (230VAC, full load)
	Current Ripple	±5% (Imax-Imin)/(Imax+Imin)
	Current Accuracy	±8% @300mA-350mA ±5% @400mA-1050mA
	Started Delay Time	≤0.5S
	PstLM	≤1
	SVM	≤0.4
	Protection	Short Circuit Protection
Overload Protection		Auto Recovery
No-load Protection		Auto Recovery
Insulation voltage		3000V 5mA 60S between P-S
Insulation resistance		>100M ohm @ 500VDC
Leakage current		< 250µA, I/P to O/P or I/P to PE @230V input
Environment	Ta/Operation Temperature	-20....+35°C
	Ts/Storage Temperature	-40....+75°C
	Tc/Enclosure Temperature	70°C
	Humidity	10%....90%RH
	Atmospheric pressure	86-108KPa
Construction	Connection Method	Push-in Terminal
	Installation	Independent
	SEC Wire preparation	0.5-1.5 [□]
	Dimension	178 x 31 x 45mm (L*W*H)
Standards	Certification	CE
	Safety Standards	EN 61347-1:2015/A1:2021, EN 61347-2-13:2014/A1:2017,EN 62493:2015
	EMC Standards	EN IEC 55015:2019,EN IEC 55015:2019/A11:2020, EN 61547:2009,EN IEC 61000-3-2:2019, EN 61547:2009,EN IEC 61000-3-3:2013/A1:2019
	Performance	EN 62384:2006/A1:2009
	Surge	L-N/2KV
Others	RoHS	complied to 2011/65/EU
	Life Time	50000h @Ta/ Tc
	Warranty	5years , F.R. < 10000ppm

Remark:

1.All Parameters, if not specified, are measured at 230VAC/50Hz and 25°C ambient temperature.

2.LED Driver is a component of the luminaires, Luminaires and wire layout will affect the EMC, please check the EMC with end products again.

3.The driver has a maximum output current of 1050mA, and the maximum output current is 1050mA when one output is used , typically 750mA per channel when two outputs are used.

2. Output Current Setting

Output Current	1	2	3	4
300mA	-	-	-	-
350mA	-	-	-	ON
400mA	-	-	ON	-
450mA	-	-	ON	ON
500mA	-	ON	-	-
550mA	-	ON	-	ON
600mA	-	ON	ON	-
650mA	-	ON	ON	ON
700mA	ON	-	-	-
750mA	ON	-	-	ON
800mA	ON	-	ON	-
850mA	ON	-	ON	ON
900mA	ON	ON	-	-
950mA	ON	ON	-	ON
1000mA	ON	ON	ON	-
1050mA	ON	ON	ON	ON

3. Output color temperature setting

Color temperature setting	C	C+W	W
OUT-V1	ON	ON	-
OUT-V2	-	ON	ON

4. Connected quantities of different current Breaker

TYPE	Connected quantities of different current Breaker						Input Voltage	Inrush Current (A)	Time
	current (A)	10	13	16	20	25			
	Installation wire diameter	1.5mm ²	2.5mm ²	2.5mm ²	4mm ²	4mm ²			
TYPE B	13	16	20	25	31	@230VAC	48	200us	
TYPE C	20	26	32	40	50				
TYPE D	32	42	51	64	80				

5. Label

KGP
KGP Electronics GmbH
Hueckstraße 19
DE-58511 Lüdenscheid
Constant Current Lighting track adaptors

LED Driver
SC42W300-1050CG-4W DUAL
For LED modules only
tc:70°C ta:35°C

PRI:220-240VAC 50/60Hz Max.0.25A
SEC:300-800mA 10-42VDC
850-1050mA 10-40VDC
NO Load:59VDC Max.42W Fmax.50N†

W -
C -
+

0.5-1.5"
8-9mm

ON OFF
1 2 3 4

P _{out} [W]	I _{out} [mA]	λ	1	2	3	4	P _{out} [W]	I _{out} [mA]	λ	1	2	3	4
12.6	300	0.86C	-	-	-	-	29.4	700	0.94C	ON	-	-	-
14.7	350	0.87C	-	-	-	ON	31.5	750	0.95	ON	-	-	ON
16.8	400	0.88C	-	-	ON	-	33.6	800	0.95	ON	-	ON	-
18.9	450	0.89C	-	-	ON	ON	34	850	0.96	ON	-	ON	ON
21	500	0.90C	-	ON	-	-	36	900	0.96	ON	ON	-	-
23.1	550	0.91C	-	ON	-	ON	38	950	0.97	ON	ON	-	ON
25.2	600	0.92C	-	ON	ON	-	40	1000	0.97	ON	ON	ON	-
27.3	650	0.93C	-	ON	ON	ON	42	1050	0.97	ON	ON	ON	ON

KGP
KGP Electronics GmbH
Hueckstraße 19
DE-58511 Lüdenscheid
Constant Current Lighting track adaptors

LED Driver
SC42W300-1050CG-4B DUAL
For LED modules only
tc:70°C ta:35°C

PRI:220-240VAC 50/60Hz Max.0.25A
SEC:300-800mA 10-42VDC
850-1050mA 10-40VDC
NO Load:59VDC Max.42W Fmax.50N†

W -
C -
+

0.5-1.5"
8-9mm

ON OFF
1 2 3 4

P _{out} [W]	I _{out} [mA]	λ	1	2	3	4	P _{out} [W]	I _{out} [mA]	λ	1	2	3	4
12.6	300	0.86C	-	-	-	-	29.4	700	0.94C	ON	-	-	-
14.7	350	0.87C	-	-	-	ON	31.5	750	0.95	ON	-	-	ON
16.8	400	0.88C	-	-	ON	-	33.6	800	0.95	ON	-	ON	-
18.9	450	0.89C	-	-	ON	ON	34	850	0.96	ON	-	ON	ON
21	500	0.90C	-	ON	-	-	36	900	0.96	ON	ON	-	-
23.1	550	0.91C	-	ON	-	ON	38	950	0.97	ON	ON	-	ON
25.2	600	0.92C	-	ON	ON	-	40	1000	0.97	ON	ON	ON	-
27.3	650	0.93C	-	ON	ON	ON	42	1050	0.97	ON	ON	ON	ON

KGP
KGP Electronics GmbH
Hueckstraße 19
DE-58511 Lüdenscheid
Constant Current Lighting track adaptors

LED Driver
SC42W300-1050CG-4G DUAL
For LED modules only
tc:70°C ta:35°C

PRI:220-240VAC 50/60Hz Max.0.25A
SEC:300-800mA 10-42VDC
850-1050mA 10-40VDC
NO Load:59VDC Max.42W Fmax.50N†

W -
C -
+

0.5-1.5"
8-9mm

ON OFF
1 2 3 4

P _{out} [W]	I _{out} [mA]	λ	1	2	3	4	P _{out} [W]	I _{out} [mA]	λ	1	2	3	4
12.6	300	0.86C	-	-	-	-	29.4	700	0.94C	ON	-	-	-
14.7	350	0.87C	-	-	-	ON	31.5	750	0.95	ON	-	-	ON
16.8	400	0.88C	-	-	ON	-	33.6	800	0.95	ON	-	ON	-
18.9	450	0.89C	-	-	ON	ON	34	850	0.96	ON	-	ON	ON
21	500	0.90C	-	ON	-	-	36	900	0.96	ON	ON	-	-
23.1	550	0.91C	-	ON	-	ON	38	950	0.97	ON	ON	-	ON
25.2	600	0.92C	-	ON	ON	-	40	1000	0.97	ON	ON	ON	-
27.3	650	0.93C	-	ON	ON	ON	42	1050	0.97	ON	ON	ON	ON

6. Electrical values

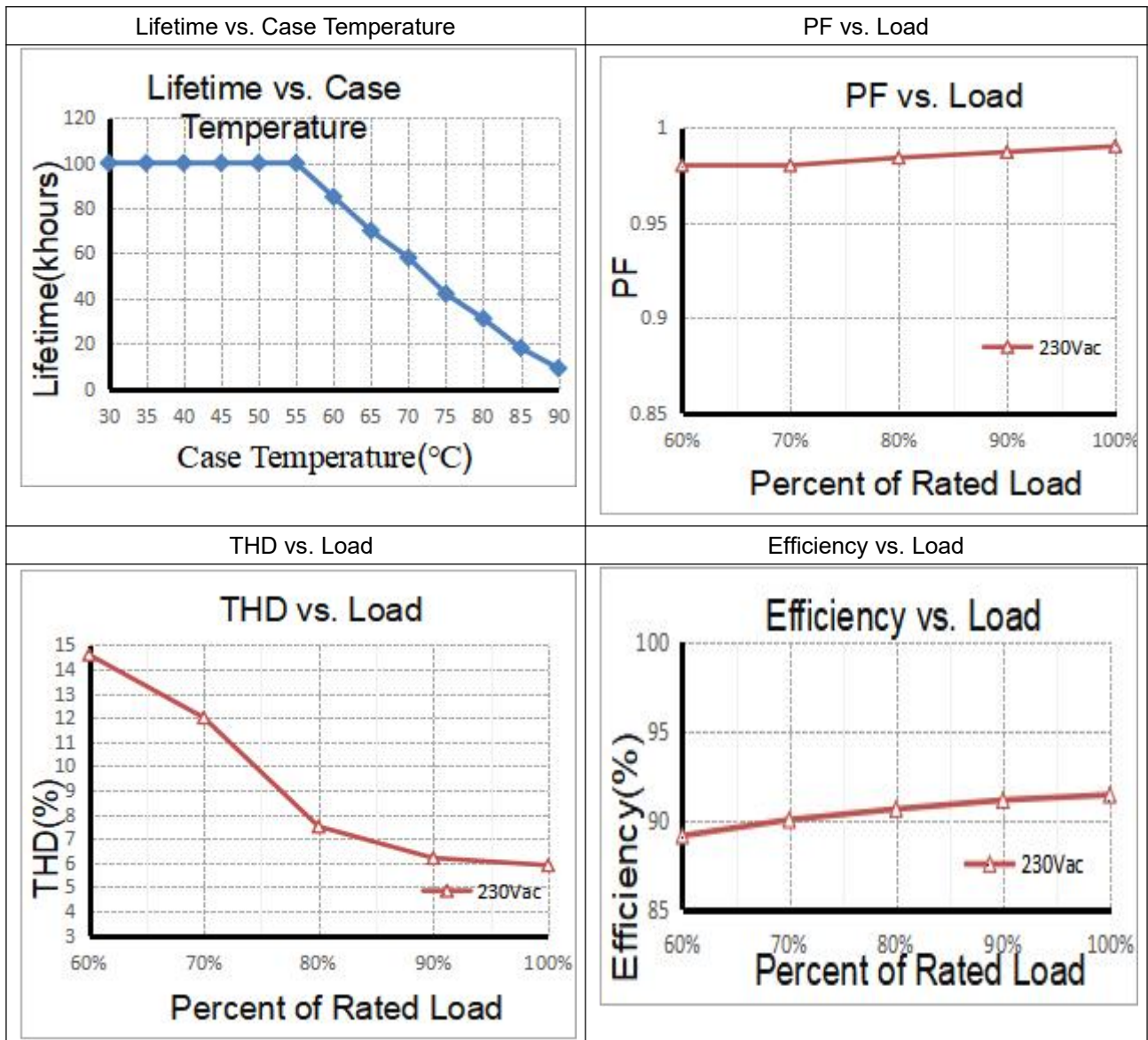

7. Dimension

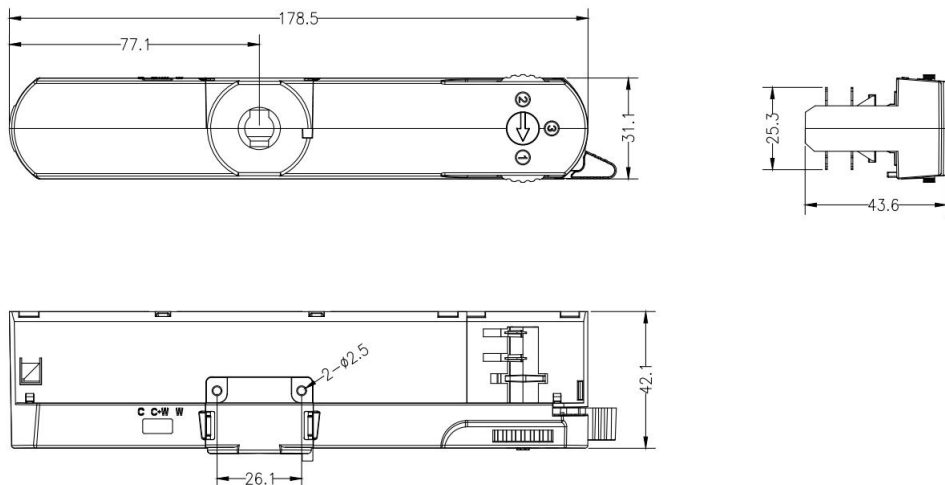

8. Wiring Diagram

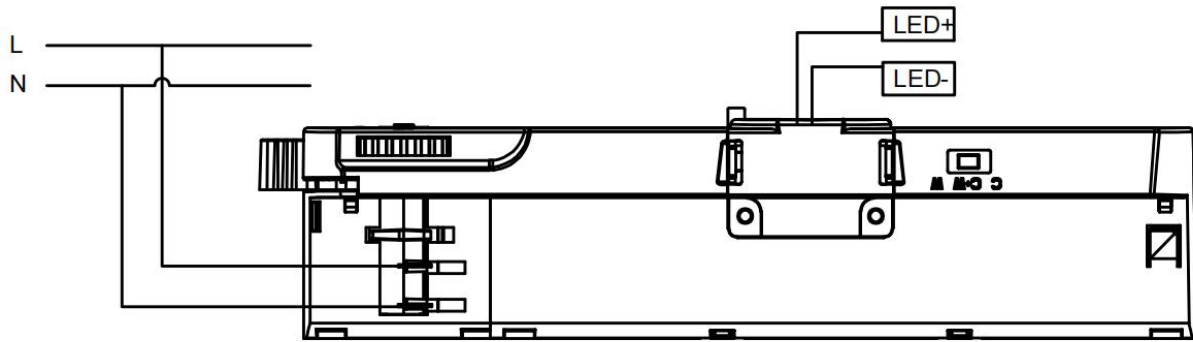

9. Packing information

Packing way	Model	Colour	Carton L*W*H(mm)	Pcs/ Carton	Net weight/ Pcs(kg)	Net weight/ Carton(kg)	Gross weight/ Carton(kg)
industrial	SC42W300-1050CG-4X DUAL	White	415*350*225	55	0.14	7.78	8.89
		Black					
		Grey					

10. Lamp Screw Type

- Optional threaded sleeve for luminaire mounting
- Suitable for M10x1x8 threaded nut
- Additional mounting equipment, e.g. M10x1x12
- aluminium, black, white
- further on request

Ordering data

Type	Colour	Article number	Qty/ctn	Weight/pcs
M10x1x8	White	AC094306	1200	0.016
	Black	AC094307	1200	0.016
	Aluminium	AC094310	1200	0.016
M10x1x12	White	AC094308	900	0.017
	Black	AC094309	900	0.017
	Aluminium	AC094305	900	0.017

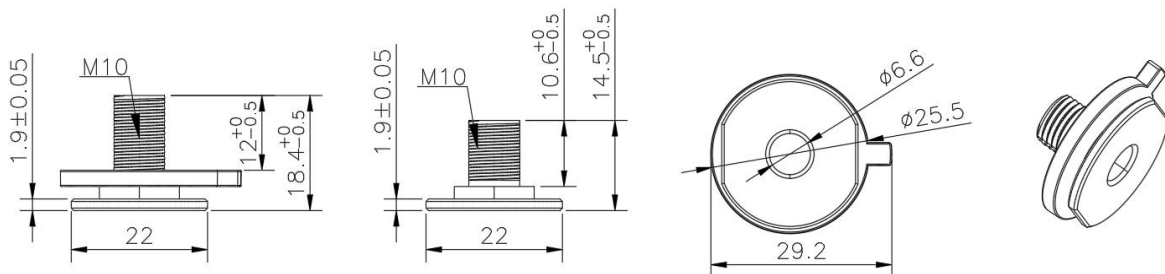

11. Suitable for following tracks

Serial number	Brand	Track model	System
1	Global	XTS 4 & XTSF 4	3P
2	Stucchi	9000XX Series	3P
3	Eutrac	2510x	3P
4	Unipro	T32B	3P
5	Ivela	7501	3P

Remark:

1. The model name is XTS 4 and XTSF 4 tracks, and its brand is Global.
2. The model name used is the 9000XX track, and its brand is Stucchi. The "XX" in the model name represents: it represents a different color.
3. The model name is 2510x tracks, and its brand is Eutrac. The "x" in the model name represents: it represents a different color (x=1 white; x=2 black; x=3 silver, x=8 grey).
4. The model name is T32B tracks, and its brand is Unipro.
5. The model name is 7501 tracks, and its brand is Ivela.

12. Phase track light rail specification:

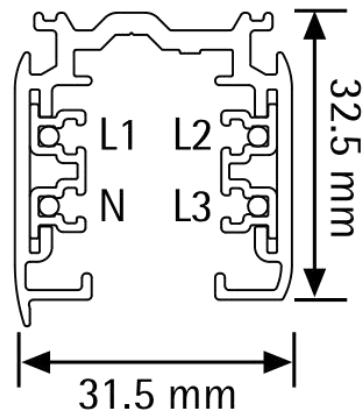

13. Lighting track adapter and rail system installation diagram:

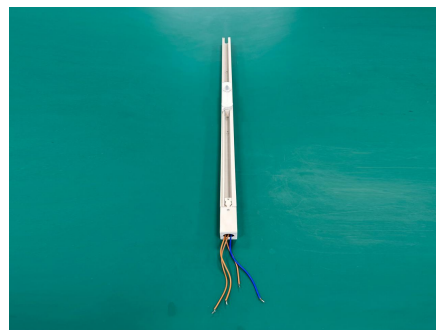

The adaptor shall be given that the use is limited to the track system specified.

14. Wiring instructions

- All connections must be kept as short as possible to ensure good EMI behaviour
- Mains leads should be kept apart from LED Driver and other leads (ideally 5 – 10 cm distance)
- Advice the maximum length of output wires is 3 m
- Secondary switching is not permitted (Except for constant voltage)
- Incorrect wiring can damage LED modules.
- The wiring must be protected against short circuits to earth (sharp edged metals parts, metal cable clips, louver, etc.)

15. REVISION HISTORY

DATE	VER	REMARK
2024-03-16	V1.0	Initial release.