

SC20W150-500CG-4X

**Constant Current Driver**

**Model: SC20W150-500CG-4W  
SC20W150-500CG-4B  
SC20W150-500CG-4G**



Model	Output Current	Input Current	Input Power	Output Power Range	PF	Efficiency	Output Voltage	No load Voltage
SC20W150-500CG-4W/ SC20W150-500CG-4B/ SC20W150-500CG-4G	150mA	0.06A	12W	3-6W	0.8	80%	20-40V	≤55V
	200mA	0.07A	14W	4-8W	0.88			
	250mA	0.08A	15W	5-10W	0.9	83%		
	300mA	0.09A	19W	6-12W				
	350mA	0.10A	22W	7-14W	0.92	85%		
	400mA	0.12A	24W	8-16W				
	450mA	0.14A	26W	9-18W				
	500mA	0.16A	27W	10-20W				

**\* Test result @230V, 50Hz, Full Load.**

**1. Parameters**

category	Item	Technical Norm
Features	Output Type	Constant Current
	Dimming Type	N/A
	Dimming Range	N/A
	IP Grade	IP20
	Insulation Class	Class II
Input	Rated Input Voltage	220-240VAC
	Range of Input Voltage	198-264VAC or 180-280VDC
	Frequency	50/60Hz
	Input Current	≤0.16A
	Input Power	≤27W
	Power Factor	≥0.92
	THD	≤20%
	No-load Power Consumption	≤0.5W
Output	Output Voltage	20-40V
	Output Current:	150/200/250/300/350/400/450/500MA
	No Load Voltage	55VDC Max
	Max. Output Power:	20W
	Efficiency	≥86%
	LF Current Ripple (< 120 Hz)	±5% (Imax-Imin)/(Imax+Imin)
	Current Accuracy	150/200/250/300mA@±7%

KGP Electronics GmbH  
Hueckstraße 19  
DE-58511 Lüdenscheid

		350/400/450/500MA@±5%
	Started Delay Time	≤0.5S
	PstLM	≤1
	SVM	≤0.4
Protection	Short Circuit Protection	Auto Recovery
	Overload Protection	Auto Recovery
	No-load Protection	Auto Recovery
	Insulation voltage	3000V 5mA 60S between P-S
	Insulation resistance	>100M ohm @ 500VDC
	Leakage current	< 250μA, I/P to O/P or I/P to PE @230V input
Environment	Ta/Operation Temperature	-20....+35°C
	Ts/Storage Temperature	-40....+85°C
	Tc/Enclosure Temperature	75°C
	Humidity	10%....90%RH
	Atmosphere	86-108KPa
	Connection Method	Push-in Terminal
Construction	Installation	Independent
	PRI Wire preparation	0.75-1.5□
	SEC Wire preparation	0.5-1.5□
	Dimension	128 x 30.8x 43mm (L*W*H)
	Certification	complied to CE
Standards	Safety Standards	EN61347-1:2015,EN61347-2-13:2014/A1:2017 ,EN62493:2015,AS/NZSIEC61347.2.13:2013, AS/NZS 61347.1:2016
	EMC Standards	EN55015:2013/A1:2015,EN61000-3-2:2014, EN61000-3-3:2013,EN61547:2009
	Performance	EN62384
	Surge	L-N/2KV
	RoHS	complied to 2011/65/EU
Others	Life Time	50000h @35°C (Ta) / 75°C (Tc)
	Warranty	5years , F.R. < 10000ppm

Remark: 1.All Parameters, if not specified, are measured at 230VAC/50Hz and 25°C ambient temperature.  
 2.LED Driver is a component of the luminaires, Luminaires and wire layout will affect the EMC, please check the EMC with end products again.

## 2. Label



**KGP Electronics GmbH**  
Hueckstraße 19  
DE-58511 Lüdenscheid  
For LED modules only



ta:35°C  
tc:75°C

**SC20W150-500CG-4**  
**LED POWER SUPPLY**  
Constant Current Lighting track adaptors  
PRI:220-240VAC 50/60Hz Max.0.16A  
SEC:150-500mA 20-40VDC  
NO Load:55VDC Max.20W Fmax.50N+

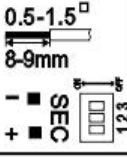
•tc  
0.5-1.5  
8-9mm



Pout (W)	Iout (mA)	In (A)	λ	1	2	3	Pout (W)	Iout (mA)	In (A)	λ	1	2	3
6	150	0.06	0.78C	-	-	-	14	350	0.10	0.9C	-	-	ON
8	200	0.07	0.8C	ON	-	-	16	400	0.12	0.9C	ON	-	ON
10	250	0.08	0.84C	-	ON	-	18	450	0.14	0.92C	-	ON	ON
12	300	0.09	0.84C	ON	ON	-	20	500	0.16	0.92C	ON	ON	ON

## 3. Connected quantities of different current Breaker

TYPE	Connected quantities of different current Breaker						Input Voltage	Inrush Current	Time
	current (A)	10	13	16	20	25			
	Installation wire diameter	1.5mm <sup>2</sup>	2.5mm <sup>2</sup>	2.5mm <sup>2</sup>	4mm <sup>2</sup>	4mm <sup>2</sup>			
TYPE B	30	39	48	60	75	@230VAC	20	40us	
TYPE C	48	62	77	96	120				
TYPE D	77	100	123	154	192				

## 4. Lifetime curve

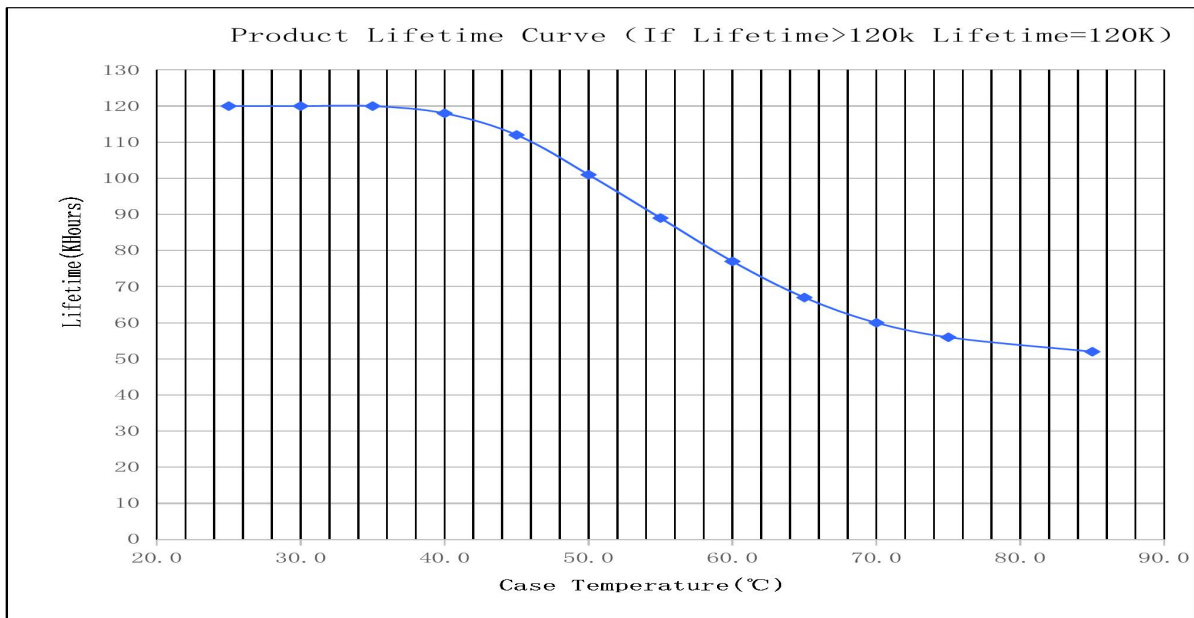

## 5. Output Current Setting

Output Current	Dial 1	Dial 2	Dial 3
150mA	-	-	-
200mA	ON	-	-
250mA	-	ON	-
300mA	ON	ON	-
350mA	-	-	ON
400mA	ON	-	ON
450mA	-	ON	ON
500mA	ON	ON	ON

## 6. Wiring Diagram

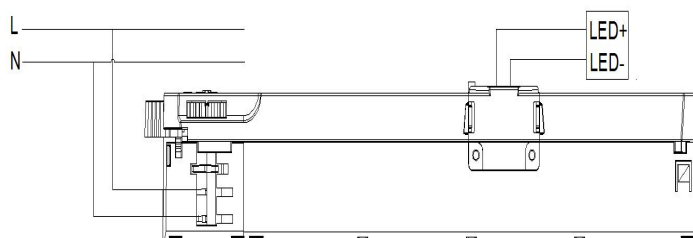

## 7. Dimension (Unit: mm)

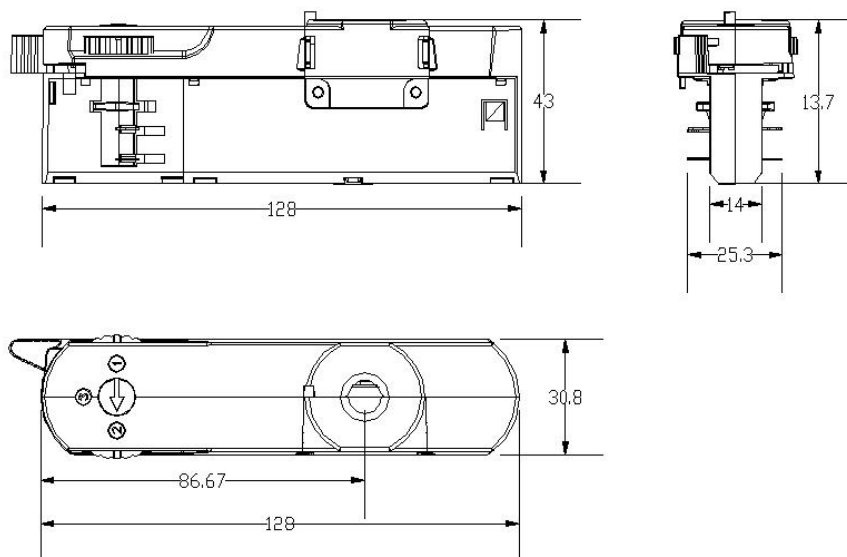

## 8. Packing information

Packing way	Carton L*W*H(mm)	Pcs/Carton	Net weight/ Pcs(kg)	Net weight/ Carton(kg)	Gross weight / Carton(kg)
With white box and manual	128x30.8x43	T.B.D	T.B.D	T.B.D	T.B.D
Without white box and manual		150	0.078	11.7	12.2

## 9. Suitable for following tracks

Serial number	Brand	Track model	System
1	Global	XTS 4 & XTSE 4	3P
2	Stucchi	9000XX Series	3P
3	Eutrac	2510x	3P
4	Unipro	T32B	3P
5	Ivela	7501	3P

### Remark:

1. The model name is XTS 4 and XTSE 4 tracks, and its brand is Global.
2. The model name used is the 9000XX track, and its brand is Stucchi. The "XX" in the model name represents: it represents a different color.
3. The model name is 2510x tracks, and its brand is Eutrac. The "x" in the model name represents: it represents a different color (x=1 white; x=2 black; x=3 silver, x=8 grey).
4. The model name is T32B tracks, and its brand is Unipro.
5. The model name is 7501 tracks, and its brand is Ivela.

## 10. Phase track light rail specification:

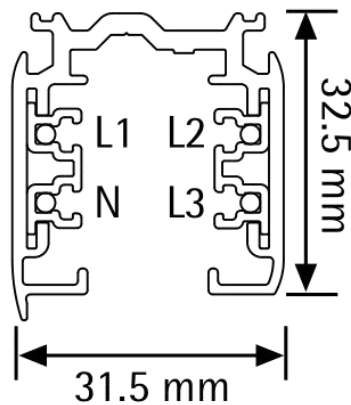
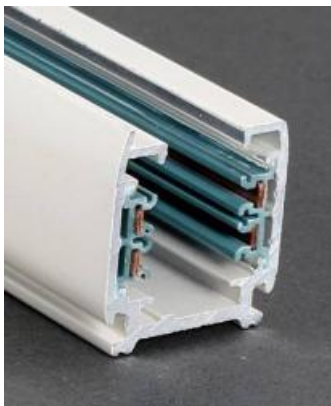

## 11. Lighting track adapter and rail system installation diagram:

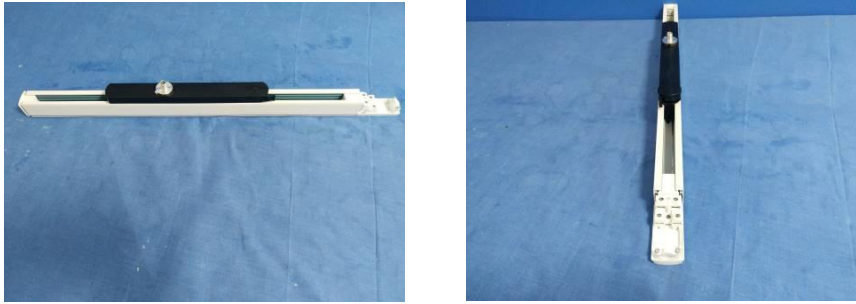

**The adaptor shall be given that the use is limited to the track system specified.**

## 12. Wiring instructions

- All connections must be kept as short as possible to ensure good EMI behaviour
- Mains leads should be kept apart from LED Driver and other leads (ideally 5 – 10 cm distance)
- Advice the maximum length of output wires is 3 m
- Secondary switching is not permitted ( Except for constant voltage )
- Incorrect wiring can damage LED modules.
- The wiring must be protected against short circuits to earth (sharp edged metals parts, metal cable clips, louver, etc.)