

SPECIFICATION

Current Rating:1.1A
 Withstand Voltage:500V AC For 1 Minute
 Contact Resistance:30 Milliohms Max.
 Insulation Resistance:1000 Megaohms Min.
 Operation Temperature:-55°C~+85°C
 Terminal Retention Force(In Housing):0.5Kg Min. Per Terminal
 Contact Insertion Force:0.115Kg Max. Per Contact Pair
 Contact Withdrawal Force:0.015Kg Min. Per Contact Pair
 Insulator:PA9T(UL94V-0),Black
 Contact:Brass
 RoHS Compliant

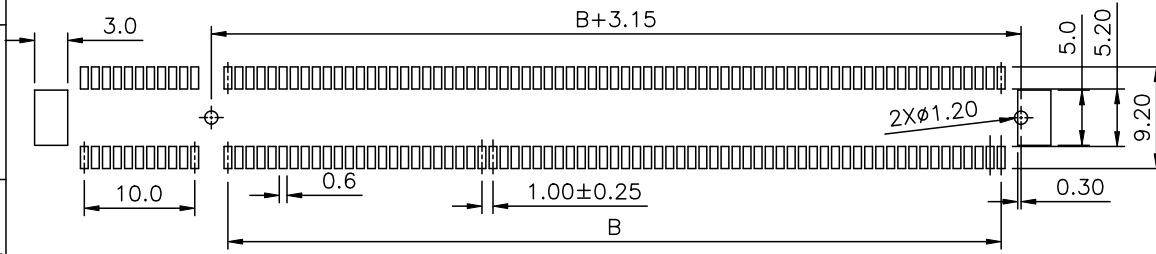

Recommended P.C.B. Layout

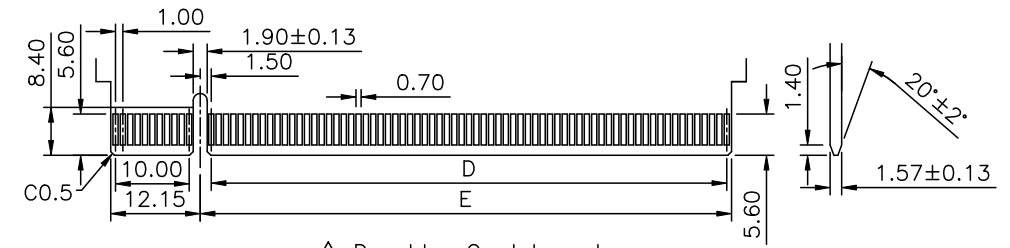
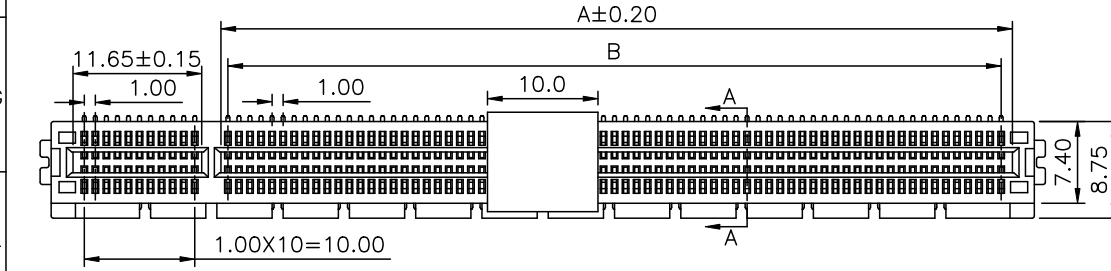

Daughter Card Layout

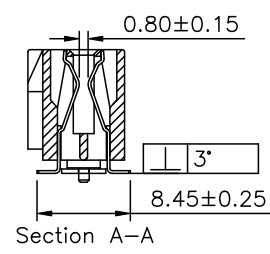
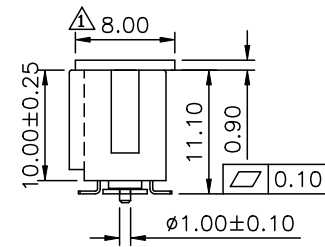
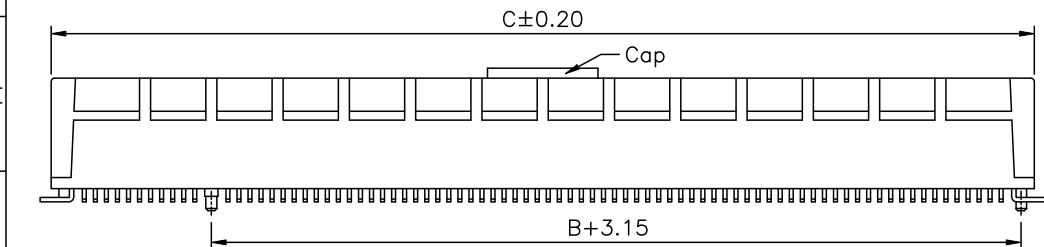

Section A-A

PCIE XXX V C - SXX - H
 (1) (2) (3) (4) (5) (6)

- (1) PCIE:1.0 PCI Express Edge Slot
- (2) XXX:No. Of Position
- (3) V:SMT Straight
- (4) C:With Cap
- (5) SXX:Contact Finish
 Blank:Gold Flash On Contact Area,
 Tin Plated On Solder Tails,Over Nickel
 S15:Gold Plated 15u" On Contact Area,
 Tin Plated On Solder Tails,Over Nickel
 S30:Gold Plated 30u" On Contact Area,
 Tin Plated On Solder Tails,Over Nickel
- (6) H:RoHS Compliant

Pin	A	B	C	D	E
036	7.65	6.00	25.00	6	8.15
064	21.65	20.00	39.00	20	22.15
098	38.65	37.00	56.00	37	39.15
164	71.65	70.00	89.00	70	72.15



CATEGORY		APPROVED BY		UNLESS OTHERWISE SPECIFIED TOLERANCES ARE .X ±0.20 .XX ±0.10 .XXX ±0.001 ANG. ±3°				
PART No. PCIEXXXVC-SXX-H		MEI						
DRAWING No. PCIEXXXVC-SXX-H		HZF			△ A2	Modify Data	HZF	08/29/2017
SCALE		REV.		CYP	△ A1	Modify Dim.	HZF	05/30/2015
NONE		A2			△ A0	NEW RELEASE	HZF	12/05/2012
				UNIT mm	NO.REV.	REVISIONS	CHK	DATE