

4~15 Pin

Latch And Polarization RIB Location



2 Pin 3 Pin

SPECIFICATION
 Current Rating:2.5A AC/DC
 Voltage Rating:250V AC/DC
 Withstand Voltage:800V AC For 1 Minute
 Insulation Resistance:1000 Megaohms Min.
 Temperature Range:-25°C~+85°C
 Insulator:PBT(UL94V-0),Black
 RoHS Compliant

MCG XX P - H
 (1) (2) (3) (4)
 (1) MCG:2.54 MCG Series
 (2) XX:No. Of Position
 (3) P:Male Housing
 (4) H:RoHS Compliant

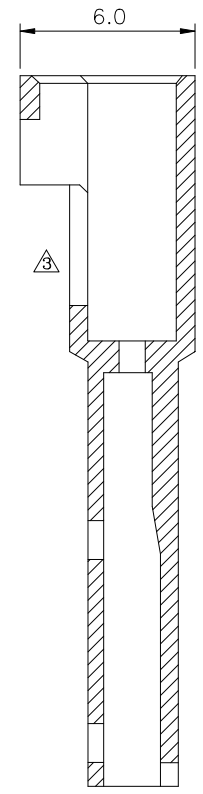
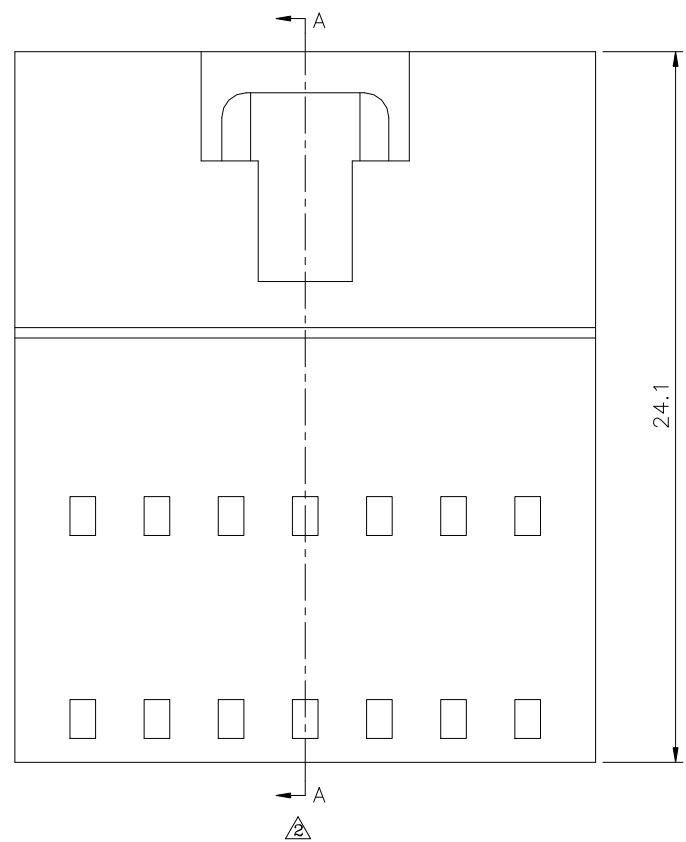

Section A-A

Pin	A	B
2	2.54	7.1
3	5.08	9.7
4	7.62	12.2
5	10.16	14.7
6	12.70	17.3
7	15.24	19.8
8	17.78	22.4
9	20.32	24.9
10	22.86	27.4
11	25.40	30.0
12	27.94	32.5
13	30.48	35.0
14	33.02	37.6
15	35.56	40.1

AUK A MEMBER OF AUK GROUP
太聯事業股份有限公司
AUK CONTRACTORS CO., LTD.

CATEGORY		APPROVED BY		UNLESS OTHERWISE SPECIFIED TOLERANCES ARE .X ±0.38 .XX ±0.25 ANG.
PART No. MCGXXP-H		MEI		
DRAWING No. MCGXXP-H		CHECKED BY HZF		
SCALE NONE		DRAWING BY CYP		
REV.	A3	UNIT mm		

NO.	REV.	REVISIONS	CHK	DATE
3	A3	Modify Data	HZF	05/03/2016
2	A2	Modify Data	HZF	03/12/2013
1	A1	Add Spec.	BECKY	2004/06/25
0	A	NEW DRAWING	HZF	2003/8/28