

NOTES:

1. Rating: 24V 30A
PITCH: 11.00 mm
2. Insulation Withstands Voltage:
AC 1500V at 1 minute
3. Insulation Resistance:
1000M Ω or more at DC500V
4. Using Temperature Range:
-40°C ~ +130°C
5. Screw Torque Value: 1.8N · m
6. Suitable Electric Wire: AWG 22~12
7. RoHS Compliance

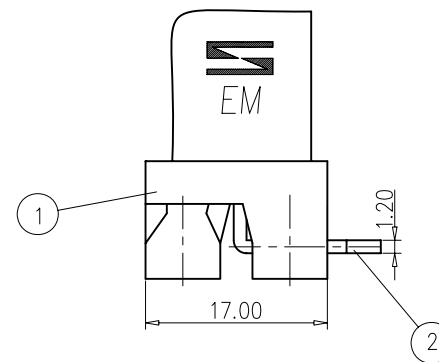

P	2	3	4	5	6	7	8	9	10
U	11.0	22.0	33.0	44.0	55.0	66.0	77.0	88.0	99.0
V	26.0	37.0	48.0	59.0	70.0	81.0	92.0	103.0	114.0
L	34.0	45.0	56.0	67.0	78.0	89.0	100.0	111.0	122.0

Normal Geometric Tolerancing				
—	//	\equiv	\perp	
0 to 100	0.2		0 to 10	0.2
over 100 to 150	0.3	0.3	over 10	0.3
over 150	0.5			
Total Pitch Tolerances		Normal dimension Tolerances		
0<U<=30	±0.20	0~30	±0.25	
30<U<=53	±0.25	over 30~53	±0.30	
53<U<=70	±0.30	over 53~70	±0.35	
70<U<=90	±0.35	over 70~90	±0.44	
90<U<=115	±0.44	over 90~115	±0.55	
115<U<=150	±0.55	over 115~150	±0.70	
150<U<=200	±0.70	over 150~200	±0.85	
200<U<=250	±0.85	over 200~250	±1.00	
250<U<=320	±1.00	over 250~320	±1.20	

3	SCREW	STEEL	M4x0.7 Ni Plated
2	SOLDER PIN	COPPER ALLOY	Tin Plated
1	HOUSING	PBT	UL94-V0 BLACK
ITEM	NAME OF PART	MATERIAL	NOTES

DWG.	HQY	DATE	12.04.16	UNITS	MM	SHEET/OF	1 / 1
CHK.		DATE		SCALE	2:1 (:)		
APP.		DATE		NAME		EM-13XX(T)	
				DINKLE ENTERPRISE CO., LTD		DWG NO. SP-03-EM13T000	

	REV.	CONTENT	CHK.	DATE
--	------	---------	------	------