

DT-7C-B01W-XX

Barrier Terminal Blocks > Single Row

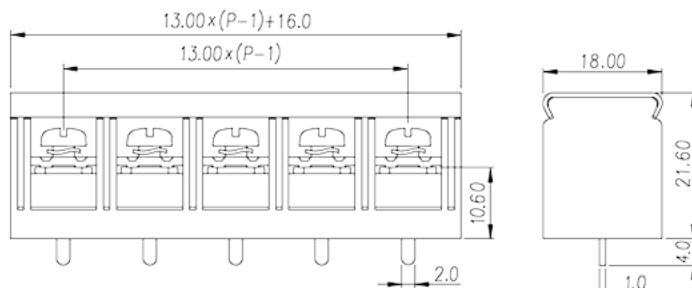
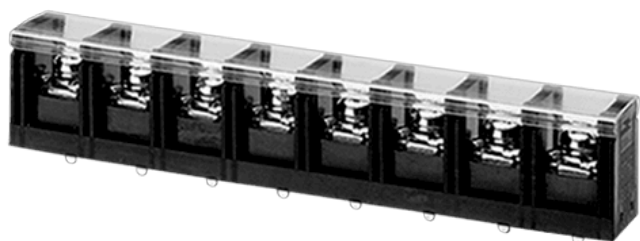

DT-7C-B01W-XX
DT-7C-B01W - series of terminal blocks
XX - number of Positions (number of Pins/Poles)

Product Description

Pitch: 13mm , M4, 600V, 40A

General information

Short description	Barrier terminal blocks , Screw connection
Connection method	Screw connection
Type of locking	Without
Category	Single Row
Pitch mm	13
Thread	M4
Level	Single Row
Pin dimensions (Thickness x Width) mm	1.0X2.0
PCB hole diameter mm	1.2x3.4

Material information

Insulation material	PBT
Flame retardant rating , compliant with UL94	V0
Color	Black
Conductor material	Copper Alloy
Plating of conductor surface	Tinned

Connection data-UL



Stripping Length mm	10~11
Slotted screwdriver size (Blade thickness x Width) mm	1.0x5.5
Philips screwdriver size	PH2
Rated torque (N.m)	1.5
Tightening torque. min N.m	1.2
Tightening torque. max N.m	1.5
Rated voltage V (UL/CUL standard group B)	600
Rated current A (UL/CUL standard group B)	40
AWG, compliant with UL/CUL, Sol. max (group B)	8
AWG, compliant with UL/CUL, Sol. min (group B)	18
AWG, compliant with UL/CUL, Str. max (group B)	8
AWG, compliant with UL/CUL, Str. min (group B)	18
Rated voltage V (UL/CUL standard group C)	600
Rated current A (UL/CUL standard group C)	40
AWG, compliant with UL/CUL, Sol. max (group C)	8
AWG, compliant with UL/CUL, Sol. min (group C)	18
AWG, compliant with UL/CUL, Str. max (group C)	8
AWG, compliant with UL/CUL, Str. min (group C)	18
Rated voltage V (UL/CUL standard group D)	600
Rated current A (UL/CUL standard group D)	5
AWG, compliant with UL/CUL, Sol. max (group D)	8
AWG, compliant with UL/CUL, Sol. min (group D)	18
AWG, compliant with UL/CUL, Str. max (group D)	8
AWG, compliant with UL/CUL, Str. min (group D)	18

Connection data-IEC

Surge voltage category	III
Pollution degree	2
Insulating material group	IIIa
Rated current A	41
Rated voltage V (II/2)	1000
Rated voltage V (III/2)	1000
Rated voltage V (III/3)	500
Rated impulse voltage KV (II/2)	8

Rated impulse voltage KV (III/2)	8
Rated impulse voltage KV (III/3)	8
Conductor cross section solid. min mm ²	0.75
Conductor cross section solid.max mm ²	6
Conductor cross section stranded. min mm ²	0.75
Conductor cross section stranded. max mm ²	6
2 conductors with same cross section, solid, max mm ²	4
2 conductors with same cross section, stranded, max mm ²	4

Environment & Safety

Back of the hand protection (YES or NO)	YES
Operating temperature. max °C	130
Operating temperature. min °C	-40

Drawings

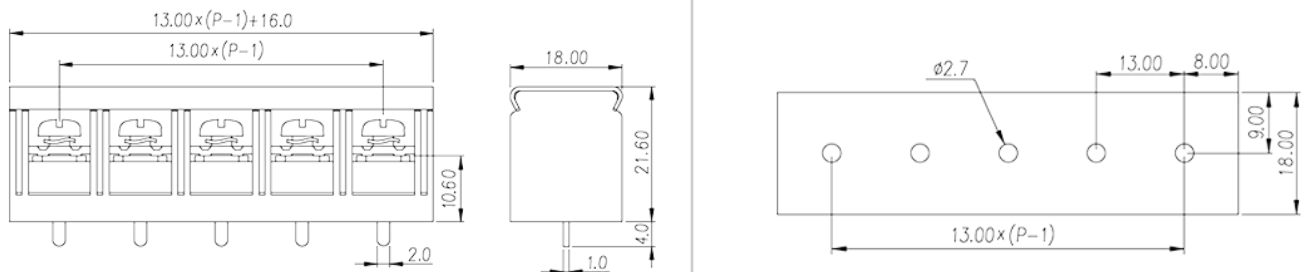

Accessories

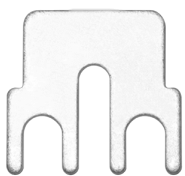

DS-701

For pitch is 13.00mm of barrier terminal blocks Material is brass Rated current 25A



DS-701R

From 13.00mm of barrier terminal blocks Material is brass Rated current 25A

Approvals

