

Femle Terminal

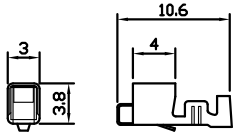

T-DS1073- S C 6 0 0 ⑥

Contact Plating
6: Tin

Femle Terminal

Wire Range		O.D of Wire
Section area mm ²	AWG#	mm
0.33~0.83	22~18	1.7~3.0

Femle Housing

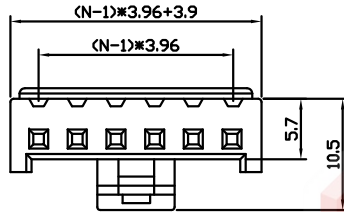

I-DS1073-S C W 0 X ⑥

No.of contact
02~13

N=No. of contacts

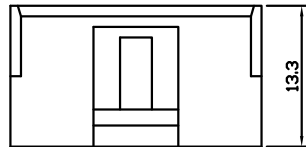

V/T Type

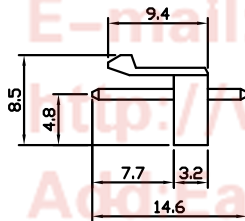
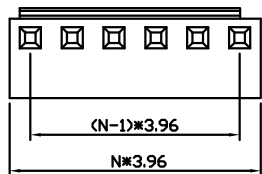

Right Angle

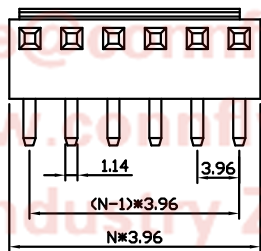

N=No. of contacts

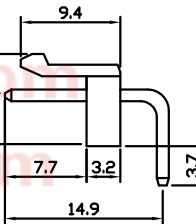

REV.	DESCRIPTION	DRAWN	CHECKED	APPROVED
A	NEW RELEASE	HP 29/06/05		LJC 29/06/05
B	ADD P/N CODE ⑥	JLZ 01/30/15'		

NOTES:

1. MAIN SPECIFICATIONS

- . Housing material: NYLON 66
- . Wire range: AWG#22~#18
- . Rated voltage: 250V
- . Rated current: 3A
- . Contact resistance: ≤ 30mΩ
- . Insulation resistance: ≥ 1000MΩ
- . Withstanding voltage: 500V,AC 1 minute
- . Temperature range: -25 ~ +85°C
- . Recommend PC board thickness:1.6mm

2. PRODUCT NUMBER CODE:

DS1073 - X X X X X

Contact Plating
6: Tin
8: Full gold flash

Housing Color
W: White

Mounting type
R: Right Angle
V: V/T type

Connector type
M: Male

No.of contact
2 to 13

Tel:86-574-63508787

Fax:86-574-63510817

E-mail:sales@connfly.com

http://www.connfly.com

Address: East Industry Zone KuangYan

Town Cixi Ningbo China

P.C:315333

GENERAL TOLERANCE		ANGLE TOLERANCE		PROJECTION		TITLE
X.	±0.60	X.	±5°	UNITS	mm	P.C.B CONNECTOR 3.96mm VH
.X	±0.38	.X	±3°	SHEET SIZE	A4	SERIES DS1073
.XX	±0.25	.XX	±2°	晨翔电子有限公司 CONNFLY CONNFLY ELECTRONIC CO. LTD		
DRAWING TYPE		CUSTOMER				
SCALE		1:1 SHEET 1 OF 1				
DRAWING NO.		C-DS1073-XXXXX-B				