

**△△ SPECIFICATION**

Current Rating: 3 Amp  
 Voltage Rating: 250V AC/RMS 60Hz  
 Contact Resistance: 20 Milliohms  
 Insulation Resistance: 1000 Megohms At 500V DC  
 Dielectric Withstanding Voltage: 1000V AC/RMS 60Hz For 1 Minute  
 Operation Temperature: -55°C~+105°C  
 Insulator: PBT+30%G.F.(UL94V-0)  
 Contact: Brass, Gold Plated On Contact Area, Tin  
 Plated On Solder Tails, Over Nickel  
 Shell: Steel, Tin Plated Over Copper  
 Boardlock: Brass, Tin Plated  
 RoHS Compliant

**△△ DDM XX P Z - XX - H**  
 (1) (2) (3) (4) (5) (6)

- (1) DDM:D-SUB DIP Straight Metal Shell With Plastic
- (2) XX:No. Of Position
- (3) P:Male
- (4) Z:Rivet With Boardlock
- (5) XX:Insulator Color  
 Blank:Black  
 BL:Blue
- (6) H:RoHS Compliant

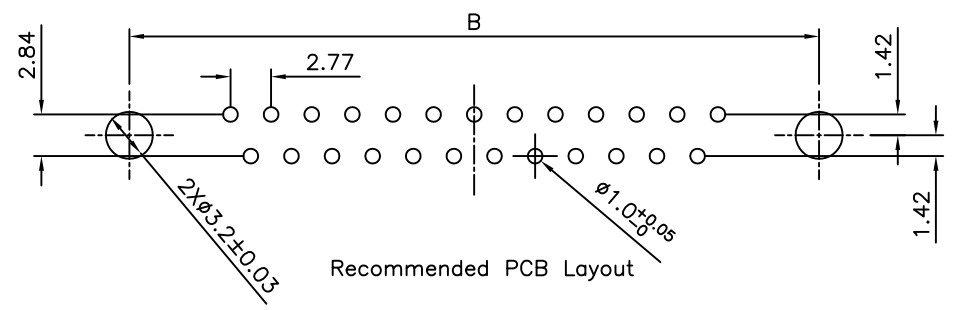

Recommended PCB Layout

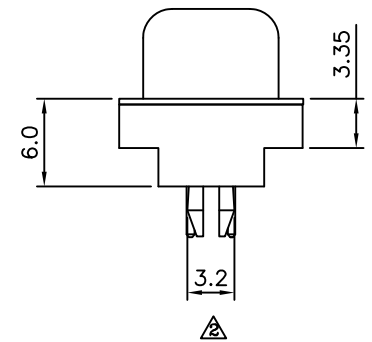
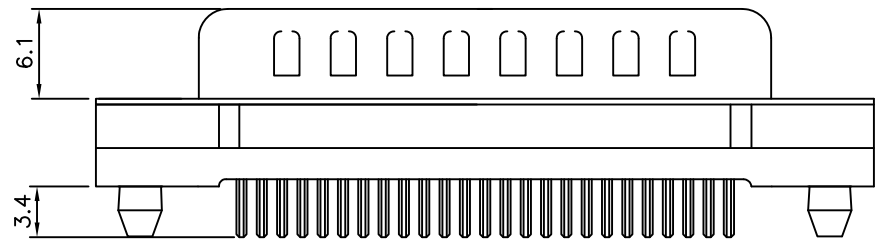
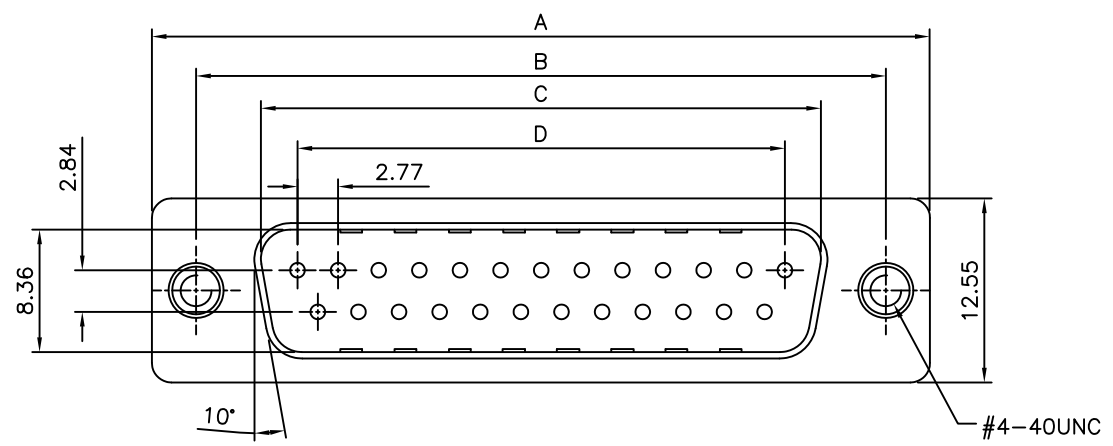

Pin	A	B	C	D
9	30.81	24.99	16.92	11.08
15	39.20	33.30	25.25	19.39
25	53.05	47.04	38.96	33.24
37	69.40	63.50	55.42	49.86



CATEGORY		APPROVED BY		UNLESS OTHERWISE SPECIFIED TOLERANCES ARE					
PART No. DDMXXPZ-XX-H		MEI		X. ±0.38 X' ±3°		B3		Modify P/N: DDMXXPZ-H	
DRAWING No. DDMXXPZ-XX-H		CHECKED BY HZF		.X ±0.25 X' ±1.0°		B2		Modify Data	
SCALE NONE		DRAWING BY CYP		.XX ±0.13		B1		Modify Spec.	
REV. B3		REV. B3		UNIT mm		B0		NEW RELEASE	
				NO. REV.		REVISIONS		CHK DATE	