

**SPECIFICATION**

Current Rating:1A Max.  
 Dielectric Withstanding Voltage:500V AC For 1 Minute  
 Contact Resistance:30 Milliohms Max.  
 Insulation Resistance:1000 Megaohms Min. At DC 500V  
 Temperature Range:-55°C~+105°C  
 Total Mating Force:6.5 Kgf Max.  
 Total Unmating Force:2.5 Kgf Min.  
 RoHS Compliant

C R Z 36 S3 - H  
 (1) (2) (3) (4) (5) (6)

- (1) C:2.16mm Centronic
- (2) R:DIP Right Angle
- (3) Z:With Boardlock
- (4) 36:No. Of Position
- (5) S3:Female Traditional Type
- (6) H:RoHS Compliant

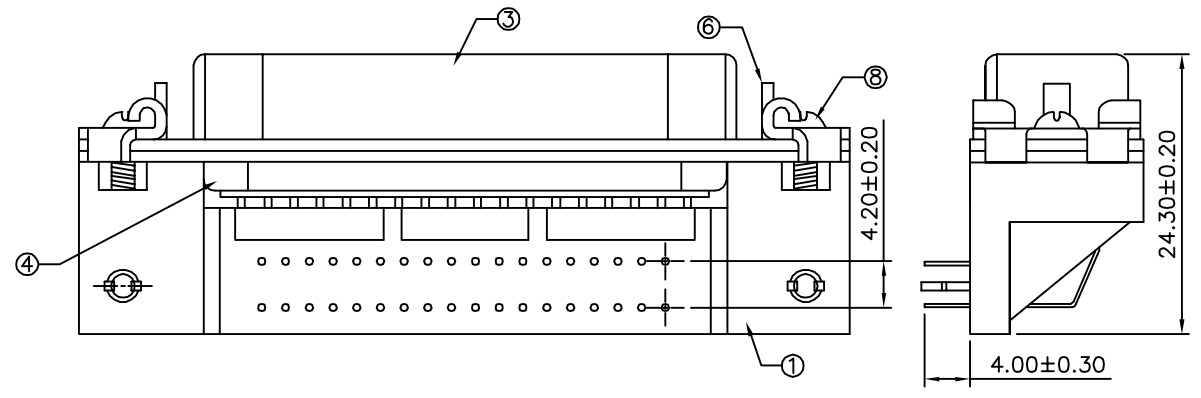
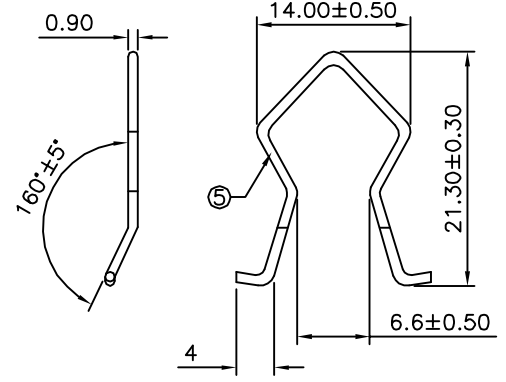
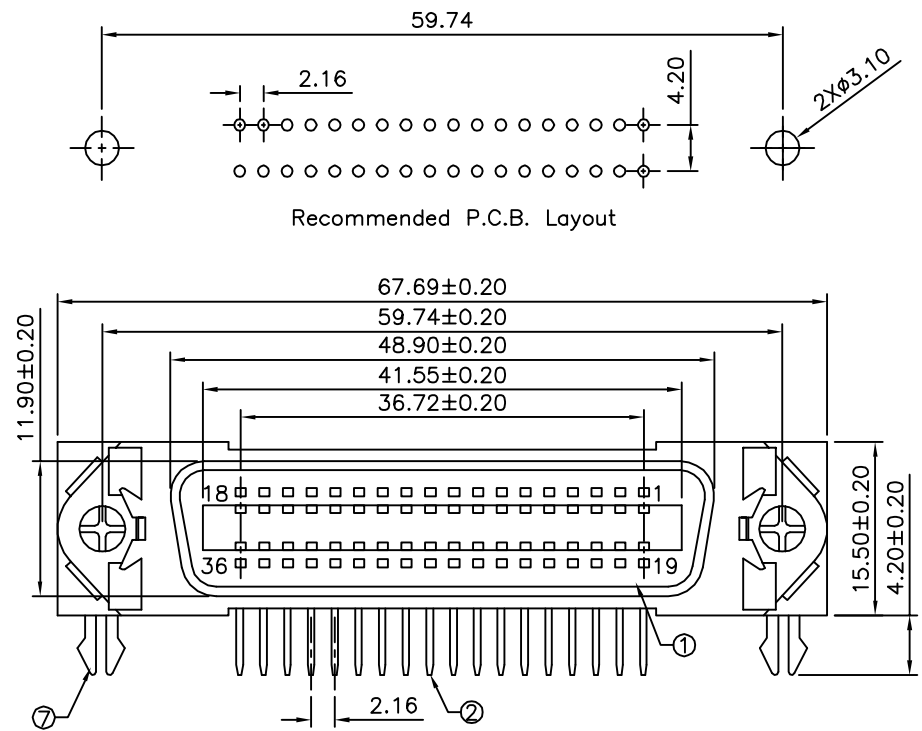

No.	Name	Material	Q'ty	Remark
①	Housing	PBT,UL94V-0	2	Blue
②	Contact	Brass	36	Gold Plated On Contact Area,Tin Plated On Solder Tails,Over Nickel
③	Front-Shell	Cold Rolled Steel	1	Nickel Plated Over Copper
④	Back-Shell	Cold Rolled Steel	1	Nickel Plated Over Copper
⑤	Spring (ø0.90)	Stainless	2	No Plated
⑥	Trangle	Cold Rolled Steel	2	Nickel Plated Over Copper
⑦	"Z" Type Boardlock	Brass	2	Tin Plated
⑧	Screw	Brass	2	Nickel Plated

**AUK** A MEMBER OF AUK GROUP  
**太聯事業股份有限公司**  
**AUK CONTRACTORS CO., LTD.**

CATEGORY		APPROVED BY		UNLESS OTHERWISE SPECIFIED TOLERANCES ARE .X ±0.30 .XX ±0.20 .XXX ±0.10 ANG. ±1°
PART No. CRZ36S3-H		EMILY		
DRAWING No. CRZ36S3-H		CHECKED BY HZF		
SCALE NONE		DRAWING BY HAO		
REV.	A0	UNIT mm		

NO.	REV.	REVISIONS	CHK	DATE
△ A0		NEW RELEASE	HZF	03/03/2014