

Constant Current Driver

Model:CCXXWXXXCG2A36-1



Model	Output Current	Input Current	Input Power	Output Power Range	PF	Efficiency (*Typical)	Output Voltage	No load Voltage
CC15W350CG2A36-1	350mA	0.12A	18.00W	5.20-15.00W	0.9C	86.5%	15-42V	55V
CC18W700CG2A36-1	700mA	0.13A	22.00W	6.30-18.00W	0.9C	86.5%	9-26V	38V
CC21W500CG2A36-1	500mA	0.14A	25.00W	7.50-21.00W	0.9C	86.5%	15-42V	55V
CC24W300CG2A36-1	300mA	0.15A	28.00W	12.00-24.00W	0.9C	87.5%	40-80V	100V
CC25W600CG2A36-1	600mA	0.16A	30.00W	9.00-25.00W	0.9C	87.5%	15-42V	55V
CC30W700CG2A36-1	700mA	0.18A	34.50W	10.50-29.40W	0.9C	87.5%		
CC34W800CG2A36-1	800mA	0.20A	39.50W	12.00-34.00W	0.9C	88.5%		
CC36W900CG2A36-1	900mA	0.22A	42.50W	13.50-36.00W	0.9C	89.5%	15-40V	
CC40W1000CG2A36-1	1000mA	0.24A	47.50W	15.00-40.00W	0.95	89.5%		
CC40W1050CG2A36-1	1050mA	0.25A	47.60W	15.70-40.00W	0.95	89.5%	15-38V	

* Test result @230V, 50Hz, Full Load.

1. Parameters

Category	Item	Technical Norm
Features	Output Type	Constant Current, SELV
	IP Grade (IEC)	IP20
	Insulation Class	Class II
Input	Rated Input Voltage	220-240 Vac
	Rated Input Voltage (perf. range)	202-254 Vac
	Range of Input Voltage(oper. safety)	198-264 Vac
	Frequency	50/60Hz perf.range: 47-63Hz oper.safety: 45-66Hz
	Input Current	≤0.16A (CC25W600CG2A36-1 230Vac,full load) ≤0.20A (CC34W800CG2A36-1 230Vac,full load) ≤0.24A (CC40W1000CG2A36-1 230Vac,full load) ≤0.25A (CC40W1050CG2A36-1 230Vac,full load)
	Input Power	≤30.00W (CC25W600CG2A36-1 230Vac,full load) ≤39.50W (CC34W800CG2A36-1 230Vac,full load) ≤47.50W (CC40W1000CG2A36-1 230Vac,full load) ≤47.60W (CC40W1050CG2A36-1 230Vac,full load)
	Power Factor	≥0.92(CC25W600CG2A36-1 230Vac,full load)

		≥ 0.94 (CC34W800CG2A36-1 230Vac,full load) ≥ 0.95 (CC40W1000CG2A36-1 230Vac,full load) ≥ 0.95 (CC40W1050CG2A36-1 230Vac,full load)
	THD	$\leq 15\%$ (25W/34W/40W230Vac,full load)
Output	Current Accuracy (@CC25W600CG2A36-1)	$\pm 6\%$ (600mA @220-240Vac)
	Current Accuracy (@CC34W800CG2A36-1)	$\pm 5\%$ (800mA @220-240Vac)
	Current Accuracy (@CC40W1000CG2A36-1)	$\pm 5\%$ (1000mA @220-240Vac)
	Current Accuracy (@CC40W1050CG2A36-1)	$\pm 5\%$ (1050mA @220-240Vac)
	Max. Output Power	25W (@CC25W600CG2A36-1) 34W (@CC34W800CG2A36-1) 40W (@CC40W1000CG2A36-1) 40W (@CC40W1050CG2A36-1)
	Current Ripple(< 120 Hz)	$\pm 5\%$ (Imax-Imin)/(Imax+Imin)
	PstLM	≤ 1 (across entire operating window)
	SVM	≤ 0.4 (across entire operating window)
	Started Delay Time	$\leq 0.5s$ (230Vac,any load)
Protection	Short Circuit Protection	Auto Recovery
	Overload Protection	Auto Recovery
	No-load Protection	Auto Recovery
	Insulation voltage/classification	I/P to O/P,3kVac/1min/double
	Insulation resistance	$> 100M$ ohm @ 500Vdc
	Touch current	I/P to O/P $< 0.7mA$ @230V input per IEC 60598-1:2015+A1:2018
Environment	Ta/Operation Temperature	$-20 \dots +45^{\circ}C$ (all versions)
	Ts/Storage Temperature	$-25 \dots +85^{\circ}C$
	Tc(max)/Enclosure Temperature	$85^{\circ}C$ (@CC25W600CG2A36-1) $85^{\circ}C$ (@CC34W800CG2A36-1) $85^{\circ}C$ (@CC40W1000CG2A36-1)
	Humidity operational/storage	10%....65%/10%....85%RH
	Atmospheric pressure	86-108kPa
Construction	Connection Method	Push-in Terminal
	Installation	Build-in & Independent
	PRI Wire preparation	Independent use:0.75-1.5 [□] (solid core and stranded strip length 8-10mm)
	SEC Wire preparation	0.5-1.5 [□] (solid core and stranded;strip length 8-10mm)
	Dimension	Independent version:102*37.6*25mm (L*W*H)
Standards	Certification	EAC ENEC CCC CE SAA
	Safety Standards	EN 61347-1:2015/A1:2021

		EN 61347-2-13:2014/A1:2017 EN IEC 62384:2020 EN 62493:2015/A1:2022
	SAA Standards	AS61347.2.13:2018 AS/NZS61347.1:2016 Inc A1
	EMC Standards	EN IEC 55015:2019/A11:2020 EN IEC 61000-3-2:2019/A1:2021 EN 61000-3-3:2013/A2:2021 EN IEC 61547:2023
	Performance	EN62384
	Surge	L-N: 1.5kV 1.2/50us per IEC61000-4-5
Others	RoHS	complied to 2011/65/EU
	Life Time	50000h@Tc=75°C CC40W1000CG2A36-1 50000h@Tc=80°C CC34W800CG2A36-1 50000h@Tc=85°C CC25W600CG2A36-1 100kh @ Tc =75°C , max. failures = 10% (CC25W600CG2A36-1) 100kh @ Tc =70°C , max. failures = 10% (CC34W800CG2A36-1) 100kh @ Tc =65°C , max. failures = 10% (CC40W1000CG2A36-1)
	Warranty	5years, F.R.<10000ppm
	Noise	≤ 20dB @ background noise ≤15dB, distance = 30cm

Remark:

1. All Parameters, if not specified, are measured at 230Vac/50Hz and 25°C ambient temperature.
2. LED Driver is a component of the luminaires, Luminaires and wire layout will affect the EMC, please check the EMC with end products again.
3. Do not install upside down.

2. Connected quantities of different current Breaker
CC25W600CG2A36-1

TYPE	Connected quantities of different current Breaker						Input Voltage (V)	Inrush Current(A)	Time (µs)
	current (A)	10	13	16	20	25			
	Installation wire diameter	1.5mm ²	2.5mm ²	2.5mm ²	4mm ²	4mm ²			
TYPE B	13	17	21	26	33	@230VAC	30	200	
TYPE C	22	29	35	44	55				
TYPE D	45	60	73	91	115				

CC34W800CG2A36-1 CC40W1050CG2A36-1

TYPE	Connected quantities of different current Breaker						Input Voltage (V)	Inrush Current(A)	Time (μs)
	current (A)	10	13	16	20	25			
	Installation wire diameter	1.5mm ²	2.5mm ²	2.5mm ²	4mm ²	4mm ²			
TYPE B	11	15	18	22	29	@230VAC	35	200	
TYPE C	19	25	30	38	48				
TYPE D	39	53	63	78	102				

3. Label (Example)

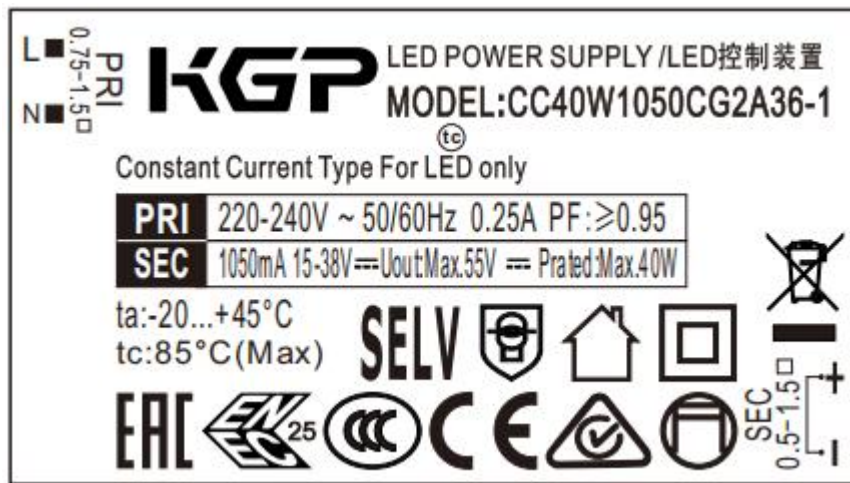

4. Electrical values

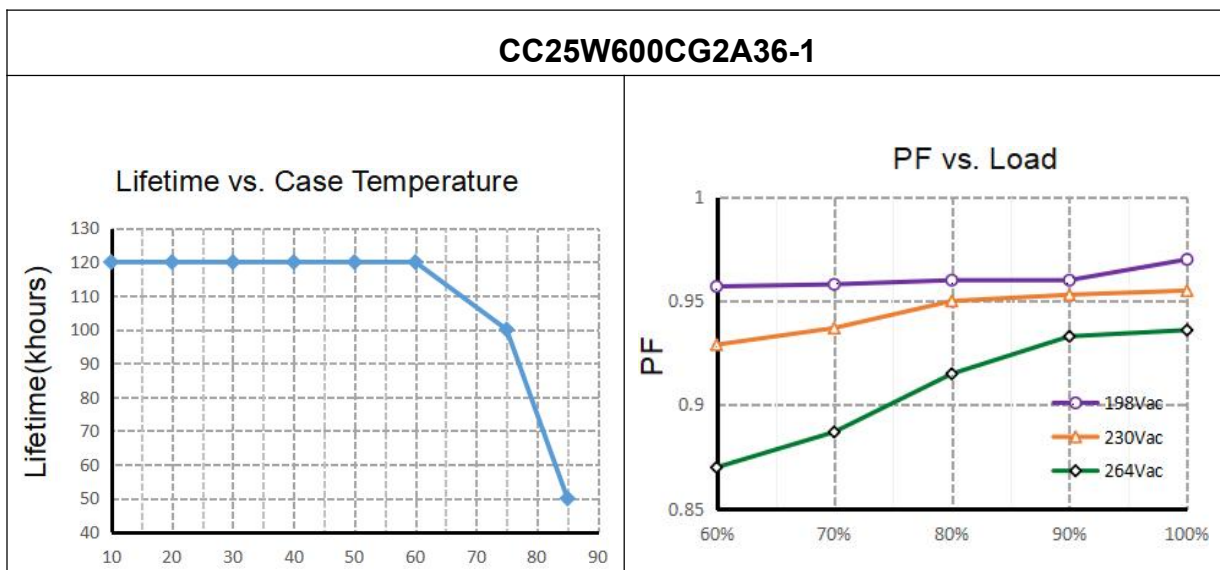

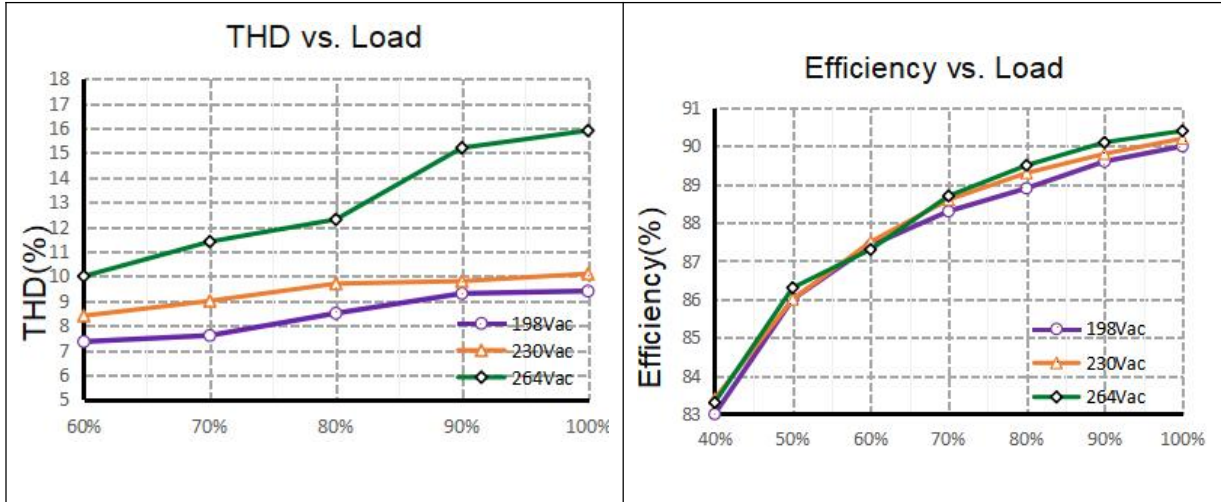

CC34W800CG2A36-1

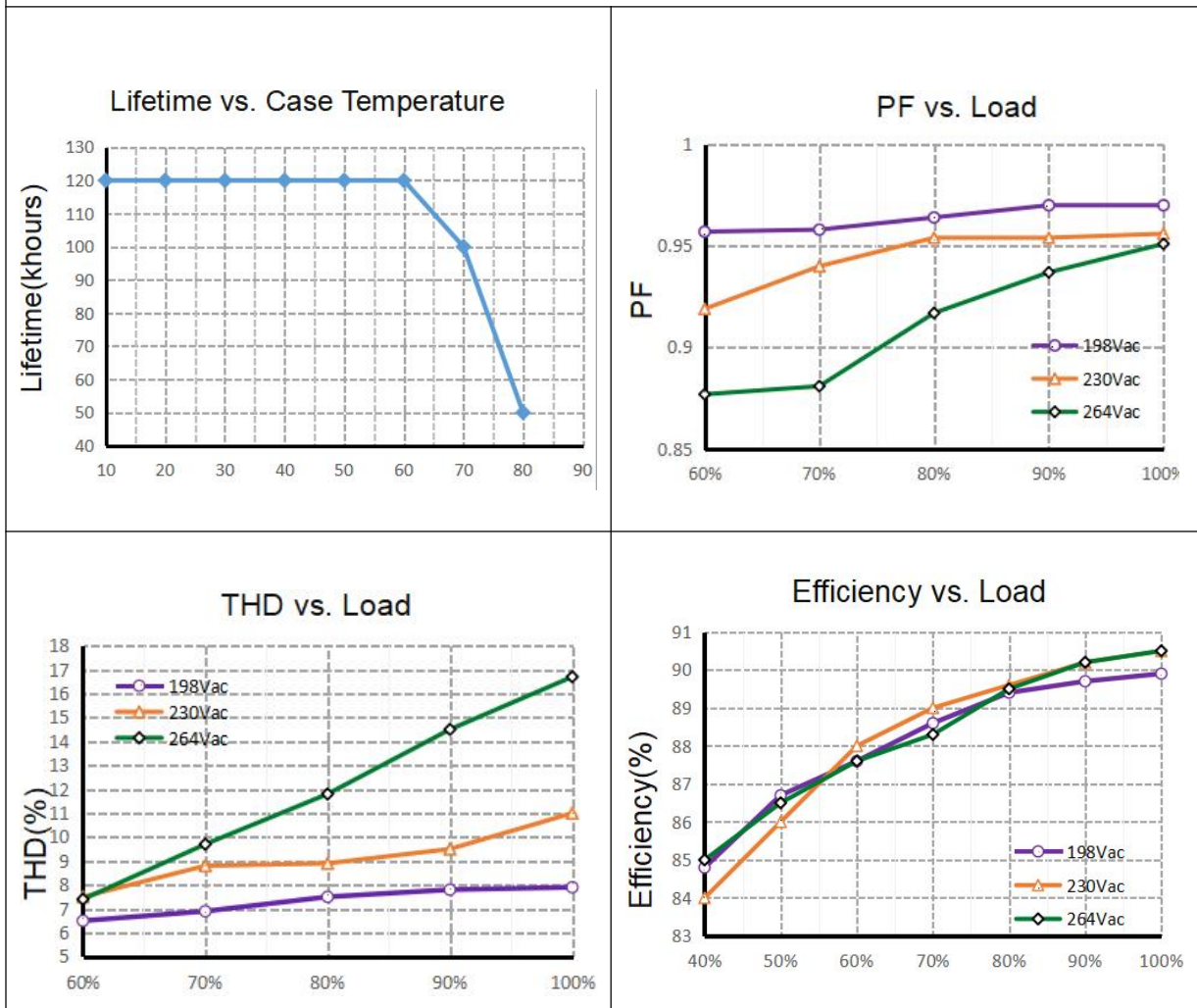

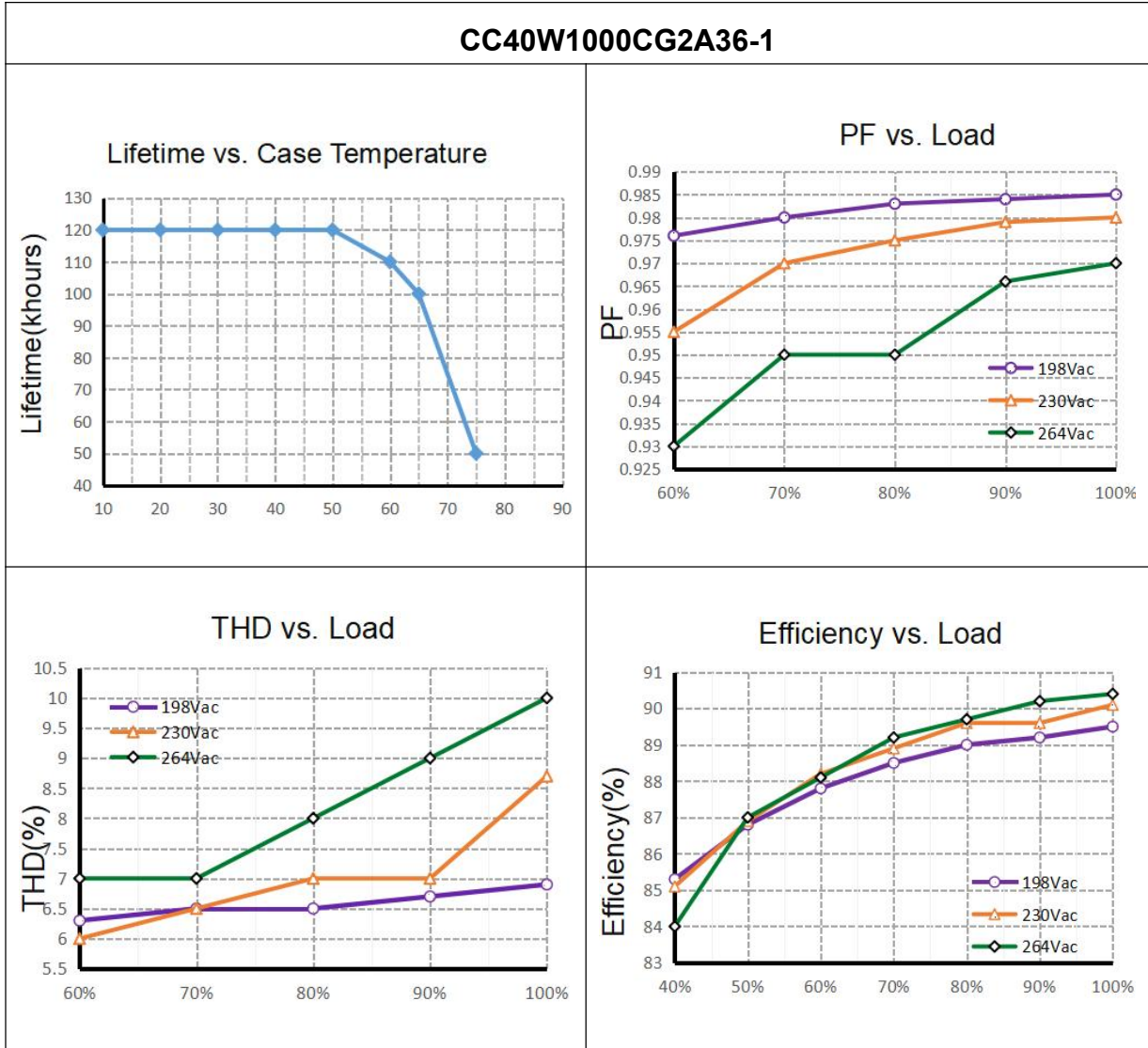

5. Dimension (Unit: mm)

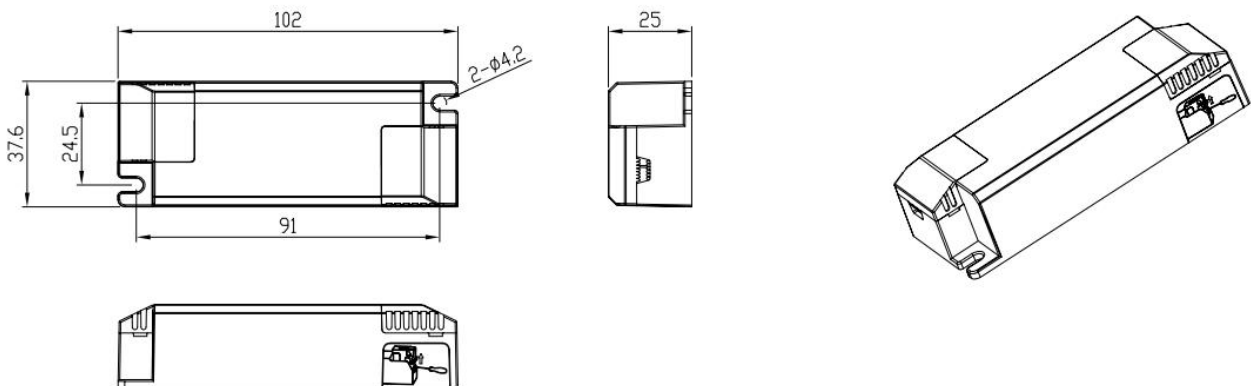

6. Packing information

Packing way	Model	Colour	Carton L*W*H(mm)	Pcs/ Carton	Net weight/ Pcs(kg)	Net weight/ Carton(kg)	Gross weight/ Carton(kg)
industrial	CC15W350CG2A36-1	White	L447*W240*H200	130	0.074	9.6	10.6
industrial	CC18W700CG2A36-1	White	L447*W240*H200	130	0.074	9.6	10.6
industrial	CC21W500CG2A36-1	White	L447*W240*H200	130	0.074	9.6	10.6
industrial	CC24W300CG2A36-1	White	L447*W240*H200	130	0.074	9.6	10.6
industrial	CC25W600CG2A36-1	White	L447*W240*H200	130	0.074	9.6	10.6
industrial	CC30W700CG2A36-1	White	L447*W240*H200	130	0.074	9.6	10.6
industrial	CC34W800CG2A36-1	White	L447*W240*H200	130	0.074	9.6	10.6
industrial	CC36W900CG2A36-1	White	L447*W240*H200	130	0.074	9.6	10.6
industrial	CC40W1000CG2A36-1	White	L447*W240*H200	130	0.076	9.9	10.9
industrial	CC40W1050CG2A36-1	White	L447*W240*H200	130	0.076	9.9	10.9

***The details shall be subject to the shipping package.**

7. Wiring Diagram

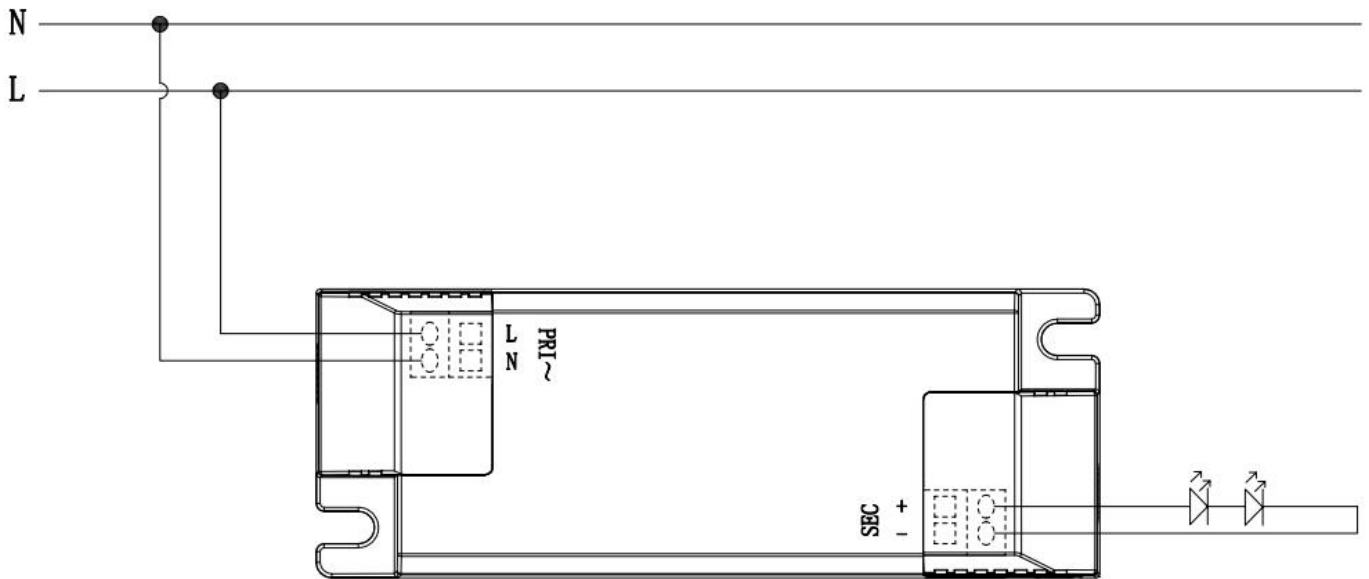

8. Wiring instructions

- All connections must be kept as short as possible to ensure good EMI behaviour
- Mains leads should be kept apart from LED Driver and other leads (ideally 5 – 10 cm distance)
- Advice the maximum length of output wires is 3 m

- Secondary switching is not permitted (Except for constant voltage)
- Incorrect wiring can damage LED modules.
- The wiring must be protected against short circuits to earth (sharp edged metals parts, metal cable clips, louver, etc.)
- Hot plug-in is not supported; damage to driver and/or LEDs may result.

9. Replace LED module

- Mains off
- Remove LED module
- Wait for 30 seconds
- Connect LED module again
- Hot plug-in or secondary switching of LEDs is not permitted; damage to driver and/or LEDs may result.

10. REVISION HISTORY

DATE	REV	Modification details
2025-12-17	V1.0	Initial release.