

P.C.B. LAYOUT (S=4/1)

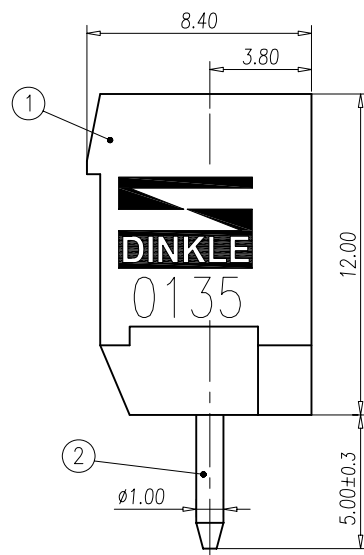

NOTES:

1. Rating: 300V 15A  
PITCH: 5.00 mm
2. Insulation Withstands Voltage:  
AC 2000V at 1 minute
3. Insulation Resistance:  
500MΩ or more at DC500V
4. Using Temperature Range:  
-40°C~+105°C
5. RoHS Compliance

Normal Geometric Tolerancing			
-	//	≡	⊥
0 to 100	0.2	0 to 10	0.2
over 100 to 150	0.3	over 10	0.3
over 150	0.5		
Total Pitch Tolerances		Normal dimension Tolerances	
0<U<=30	±0.20	0~30	±0.25
30<U<=53	±0.25	over 30~53	±0.30
53<U<=70	±0.30	over 53~70	±0.35
70<U<=90	±0.35	over 70~90	±0.44
90<U<=115	±0.44	over 90~115	±0.55
115<U<=150	±0.55	over 115~150	±0.70

ITEM	NAME OF PART	MATERIAL	NOTES
2	SOLDER PIN	COPPER-ALLOY	Tin Plated
1	HOUSING	PA66	UL94-V0 GREY

DWG.	ZYJ	DATE	12.10.12	UNITS	MM	SHEET/OF	1 / 1
CHK.		DATE		SCALE	5:1 ( : )		
APP.		DATE		NAME		0135-10XX	
				DINKLE ENTERPRISE CO.,LTD		DWG NO. SP-03-013510XX	

REV.	CONTENT	CHK.	DATE
②			